

OmniVerse Workcenters-Preconfigured

OmniVerse is an all in one work center, versatile enough to allow you to customize to your needs.

The preconfigured workcenters below give you different options all in 1 part number. Need add an additional accessory, go to the Accessory page to add that item to your workcenter.

All benches come standard with a Hardwood Ash Top & (2) 6 outlet Electrical Rails
Need to build a custom Workcenter head to the next 3 pages to configure one.

Part No.	Description
OV6-CCD-001	6ft Bench w/Overhead light, Lower Shelf, (2) Lower cabinets, (1) Adjustable shelf, (1) Overhead cabinet & (8) 2"H x 4-1/4"W removable drawers
OV6-CLD-001	6ft Bench w/Overhead light, Lower Shelf, (1) Lower cabinet,(1)Leg, (1) Adjustable shelf, (1) Overhead cabinet & (8) 2"H x 4-1/4"W removable drawers



Part No.	Description
OV6-CCD-002	6ft Bench w/Overhead light, Lower Shelf, (2) Lower cabinets, (1) Overhead cabinet, (1) Upper & (1) lower Pegboard back & (1)Lower Solid Back w/ Tack board
OV6-CLD-002	6ft Bench w/Overhead light, Lower Shelf, (1) Lower cabinet,(1) Leg, (1) Overhead cabinet, (1) Upper & (1) lower Pegboard back & (1)Lower Solid Back w/ Tack board

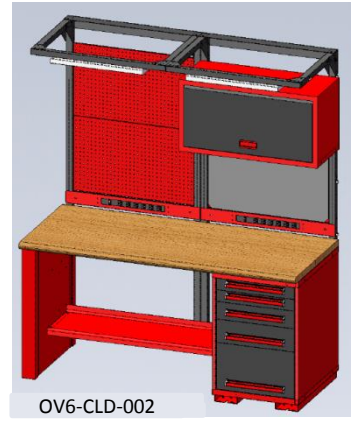
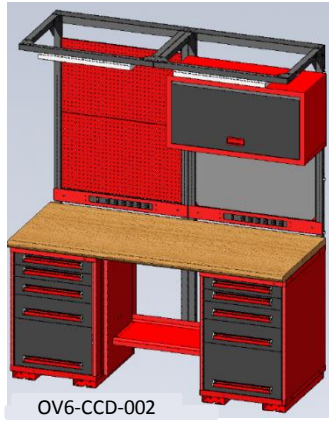

Part No.	Description
OV6-CCD-003	6ft Bench w/Overhead light, Lower Shelf, (2) Lower cabinets, (1) Overhead cabinet, (1) Lower Pegboard back, (1)Upper Solid Back & (1) Lower Solid Back w/ Tack board
OV6-CLD-003	6ft Bench w/Overhead light, Lower Shelf, (2) Lower cabinets, (1) Overhead cabinet, (1) Lower Pegboard back, (1)Upper Solid Back & (1) Lower Solid Back w/ Tack board

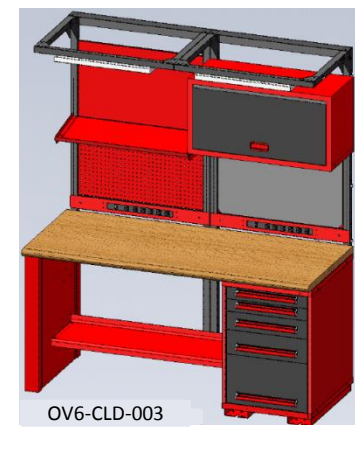
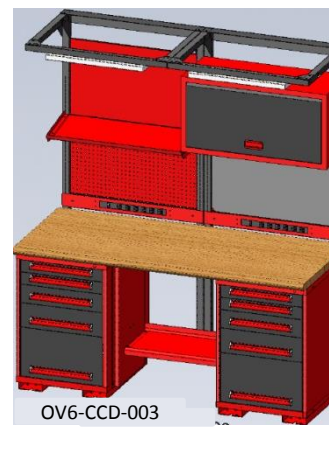

*Each cabinet comes w/ (2) 3"H, (1) 4-1/2"H, (1) 6"H & (1) 12" H 200lb drawers

**Comes w/locks on lower cabinets.

*** Cabinet & Leg can be located on either end

OmniVerse Workcenter-Custom

The Workcenters below all have a Hardwood Ash top that comes with either two cabinets with a lower shelf or 1 cabinet and a leg with a lower shelf. Allowing you to customize your drawer sizes if need be. It also includes the bracing & lights in the back for overhead lighting and (2) 6 outlet electrical rails above your top.

Head to the accessories to add overhead cabinets, pegboard, tack board, removable drawers, tool holders, spool holders and much more to make your work center function the way you need it to.

OV6-CLE

NO drawers

30"D x 72"W x 84"H (Desk 35-1/8"H)

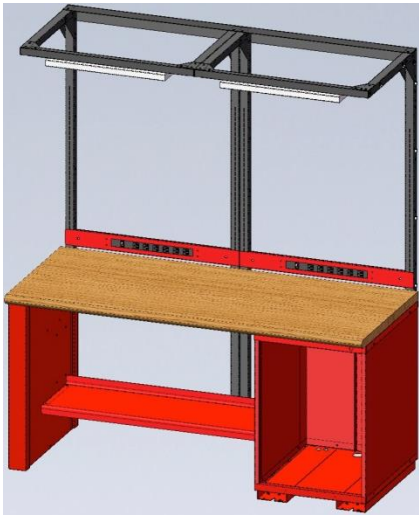

OV6-CCE

NO drawers

30"D x 72"W x 84"H (Desk 35-1/8"H)

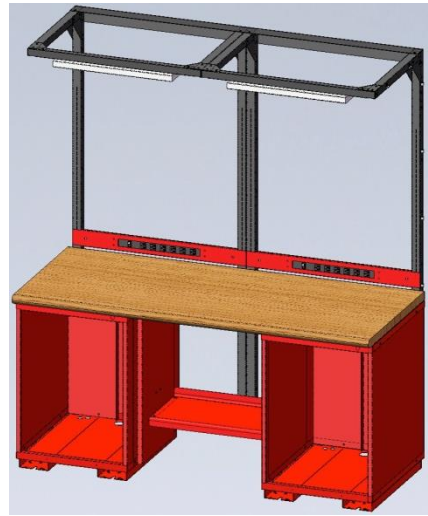

OV6-CLD *

30"D x 72"W x 84"H (Desk 35-1/8"H)



OV6-CCD *

30"D x 72"W x 84"H (Desk 35-1/8"H)



*Each cabinet comes w/ (2) 3"H, (1) 4-1/2"H, (1) 6"H & (1) 12" H 200lb drawers
**You can not use a Steel or Stainless Steel (no wood core) top on these benches.
*** Cabinet & Leg can be located on either end

OmniVerse Workcenter Accessories

Drawers (for empty cabinets)

22-1/2" 200 lb. Drawers (95 points to fill cab.)	Description	Points
8623-10	3"H Drawer	10
8624-15	4-1/2"H Drawer	15
8625-20	6"H Drawer	20
8626-25	7-1/2"H Drawer	25
8627-30	9"H Drawer	30
8628-35	10-1/2"H Drawer	35
8629-40	12"H Drawer	40



*For more information on these drawers and for divider kits see page 44.

Overhead Cabinet/Sloped Shelf/Lock

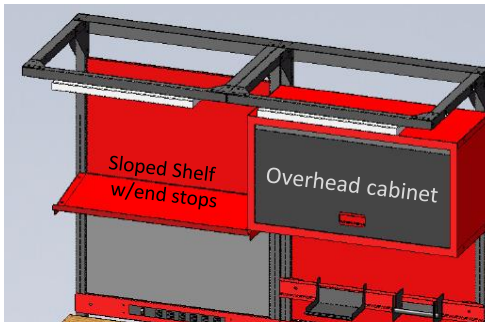

Part No.	Description
AFCAB361518	36wx15dx18.5h Cabinet/retractable door
AFASHELF3612	12dx36w Adj. Sloped Shelf (can also add 120 pts in drawers to rest ontop)
AFASHELF12ES	Pair End Stops for sloped shelf
4101	Lock for drawer cabinet

Tool Accessories

Part No.	Description
AFRAIL36	36"w Tool Rail
AFSPOOL	Spool Holder (need tool rail)
AFTRAY	Tool Tray (need tool rail)

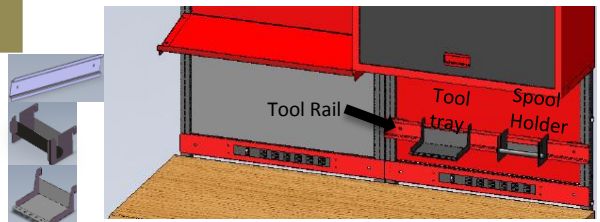

OmniVerse Workcenter Accessories Cont.

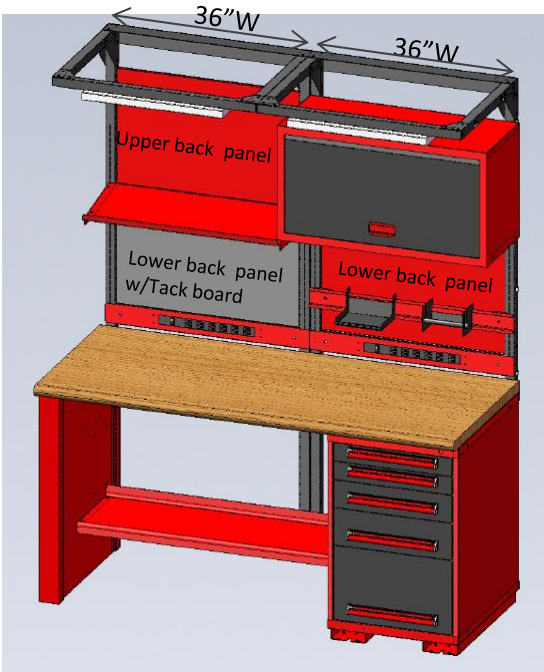

36"W Back Panels/Tack board

Part No.	Description
AFBPL36	Lower Back Panel Solid Steel, 31-17/32"W x 19-1/8"H
AFBPU36	Upper Back Panel Solid Steel, 31-17/32"W x 18-35/64"H
AFPEGL36	Lower Pegboard Back Panel Steel, 31-17/32"W x 19-1/8"H
AFPEGU36	Upper Pegboard Back Panel Steel, 31-17/32"W x 18-35/64"H
AFTB36	Gray Cloth Tack board 31-1/4"W x 19"H x 1/2"Thick (Must also order an upper or a lower back panel to attach to.)

To close off 1 entire 36"W top section of the upper unit use both an upper and lower panel (pictured on the left hand side), if you have a cabinet on the upper part use 1 lower panel to close it off below it. (pictured on the right hand side, please note you can not use a upper back panel behind the cabinet.) If you close the entire back of the bench on both 36"W sides you need 2 lowers and 2 uppers.

Removable Drawers

Part No.	Description	Divider #	Points
2"H Rail			
AFDWRRAIL2	36"W Drawer Rail	-	Holds 120
2"H Drawers			
8532	4-1/4"W x 11"D	8732	15
8534	5-5/8"W x 11"D	8734	20
3-1/8"H Rail			
AFDWRRAIL3	36"W Drawer Rail	-	Holds 120
3-1/8"H Drawers			
8504	4-1/4"W x 11"D	8709	15
8505	5-5/8"W x 11"D	8720	20
8553	8-3/8"W x 11"D	8753	30
8556	11-1/4"W x 11"D	8756	40

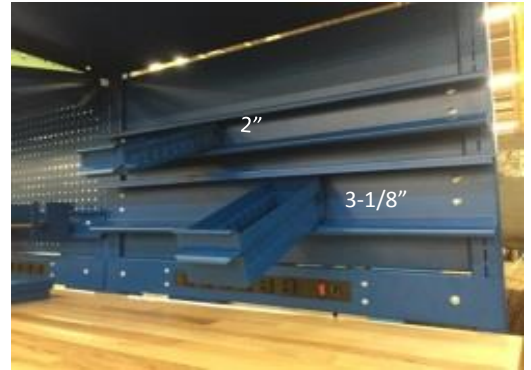

Order the correct height rail with the correct height drawers.

Each rail can hold up to 120 points of drawers, each drawer has a point system add them up to fill your rail with a full row of drawers.