

EQUIPTO

1. CASTER CHANNEL ASSEMBLY

#10176 PLASTIC BUMPER (4)

NOTE:

MAKE TWO CASTER CHANNEL ASSEMBLIES:
ONE USING FOUR SWIVEL CASTERS AND
TIGHTEN ALL SCREWS SECURELY.

#11607 SWIVEL CASTER

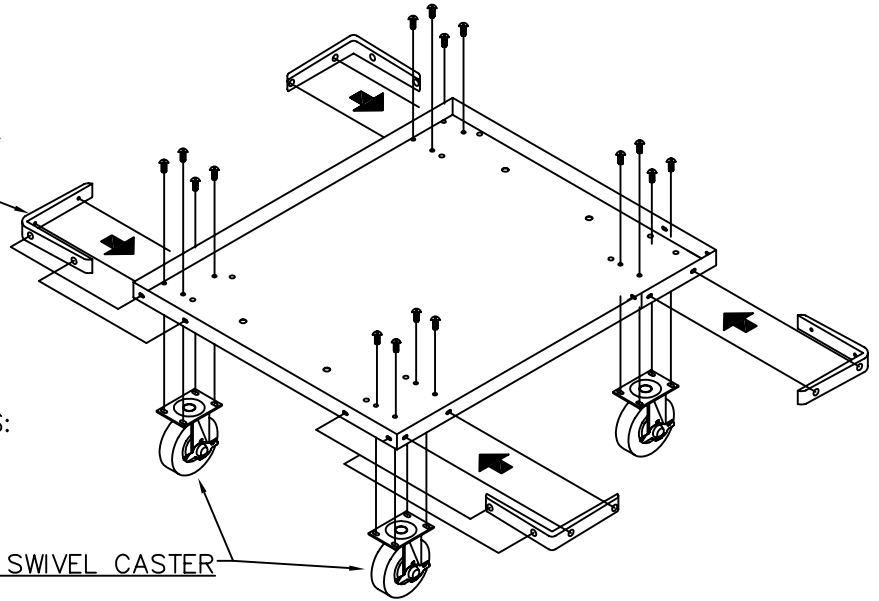

2. GUSSET ASSEMBLY

NOTE:

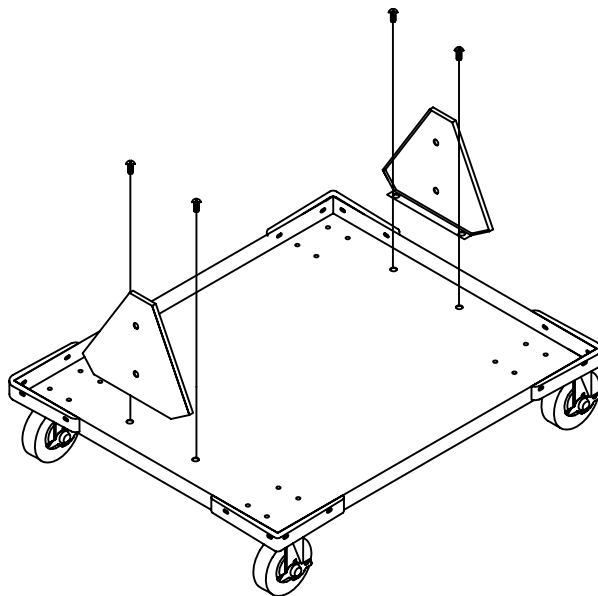

3. TRUSS ASSEMBLY

NOTE:

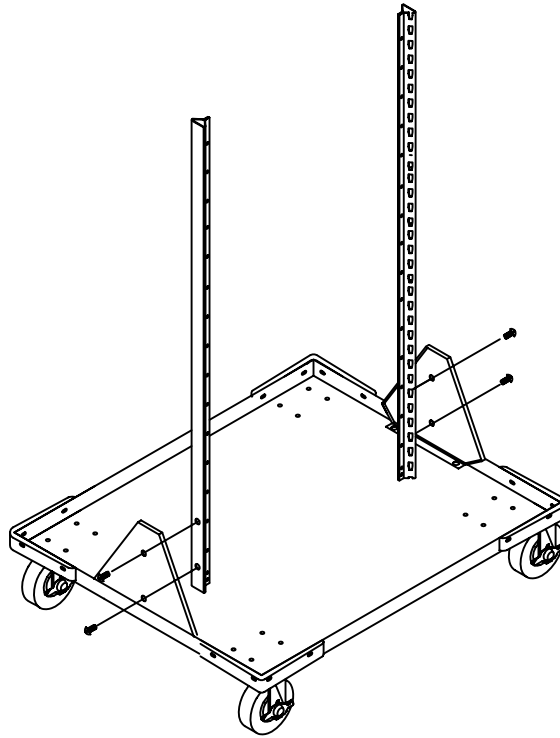

4. WIRE DECK PANELS INSTALLATION

NOTE

INSERT WIRE END PANEL BETWEEN FLANGES OF THE UPRIGHTS AND FASTEN AS SHOWN. MAKE CERTAIN SLOTS IN BOTH UPRIGHTS ARE FACING IN THE SAME DIRECTION BEFORE BOLTING. (SEE SLOT BELOW) MAKE TWO END FRAME ASSEMBLIES. TIGHTEN SCREWS SECURELY.

SLOT TOP

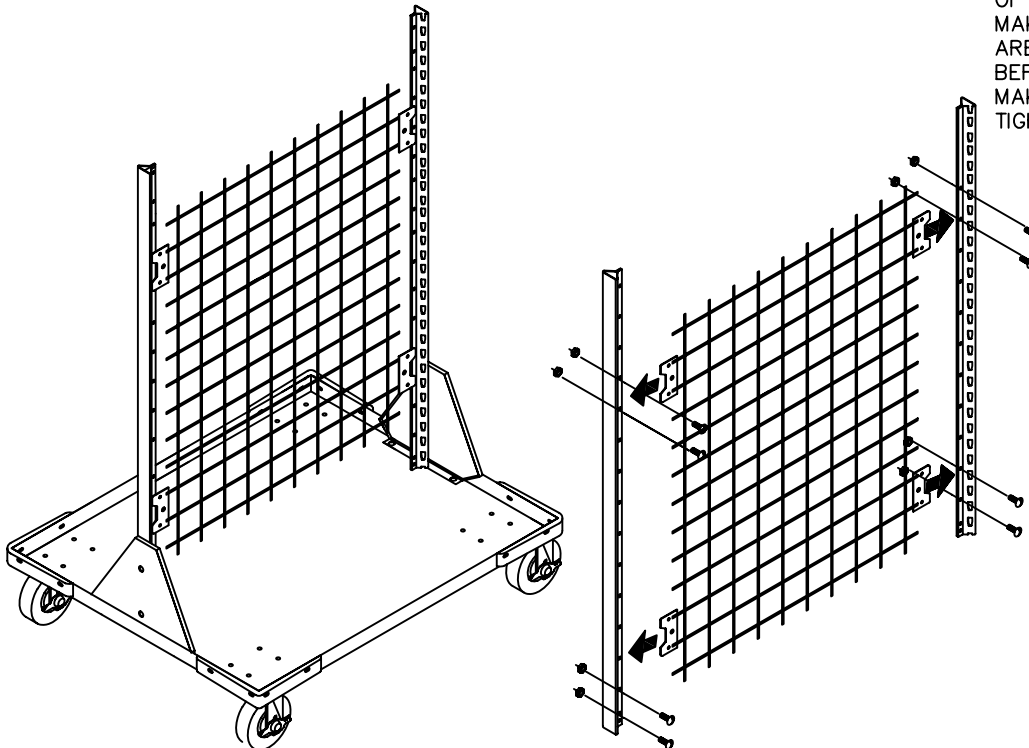

#13160 SLOTTED TRUSS SCREW
#10-24 X 3/8"

#13033 #10-24 HEX NUT

(8 PER END PANEL ASS'Y)



2. FRONT TO REAR BRACE TRUSS

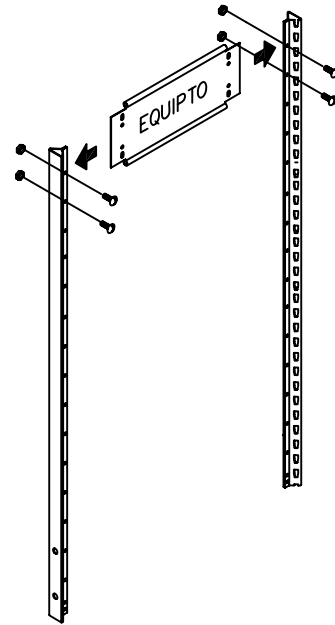
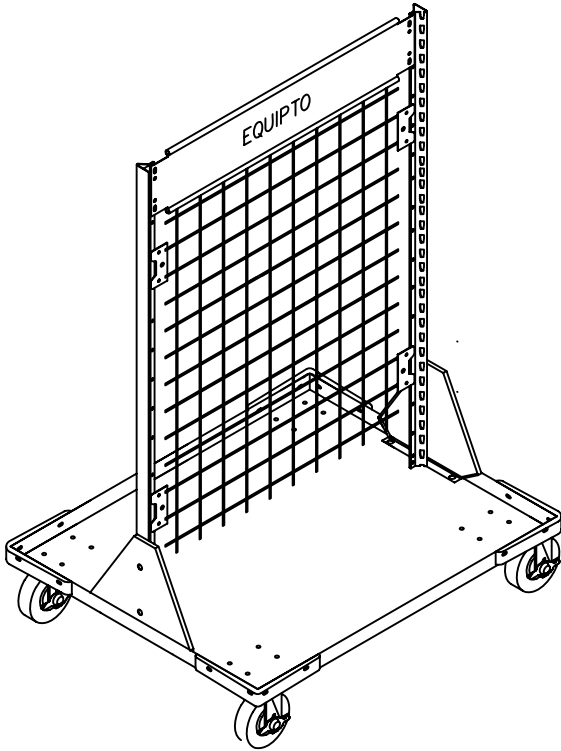

5. SPRING CLIP INSTALLATION

NOTE:

AFTER PLACING WIRE DECK PANELS ON THE TRUSSES, INSTALL FOUR (4) SPRING CLIPS, ONE AT EACH CORNER OF EACH PANEL.

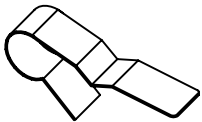

#10188
SPRING CLIP

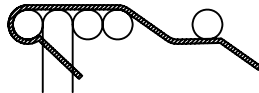

6. PLASTIC CAP INSTALLATION

NOTE:

INSTALL ONE PLASTIC CAP INTO TOP OF EACH POST.

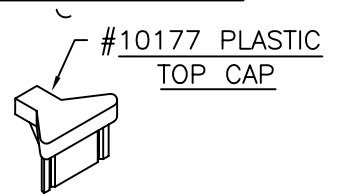

#10177 PLASTIC
TOP CAP

