

44220

---

**EQUIPTO**

---

V-Grip Rack Assembly.  
Instructions

**READ INSTRUCTIONS BEFORE ASSEMBLING**

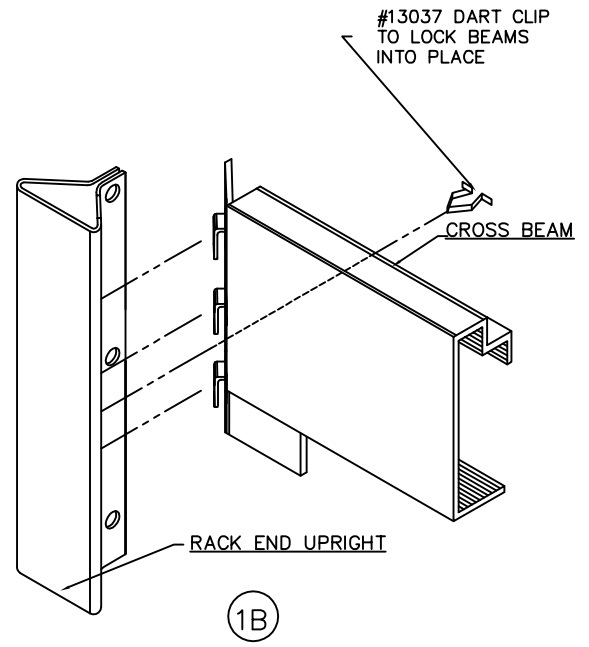
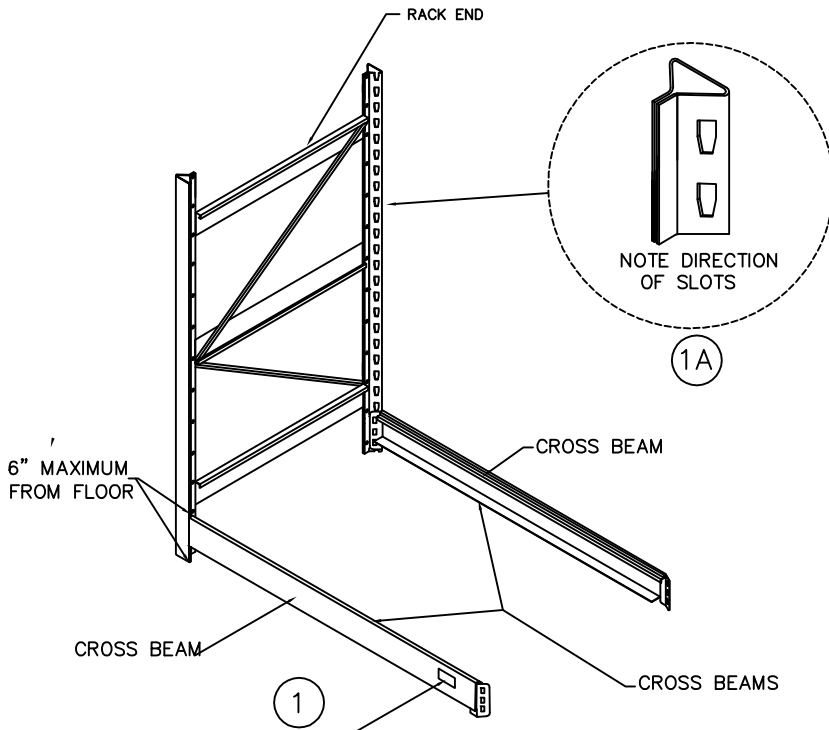

1

1B

**IMPORTANT**

BEAM PART NUMBER & WEIGHT CAPACITY PER PAIR OF BEAMS IS STAMPED ON EACH BEAM. BEAMS PLACED OPPOSITE EACH OTHER IN RACK MUST HAVE THE SAME WEIGHT CARRYING CAPACITY.

STEP 1. STAND ONE RACK END VERTICALLY, NOTE THAT LARGER PORTION OF UPRIGHT SLOTS ARE TOWARD THE TOP.(SEE FIG. A & 1A)

STEP 2. INSERT HOOKS ON END OF ONE CROSS BEAM INTO SLOTS IN RACK END UPRIGHT AT LOWEST LEVEL AND PUSH DOWN. (SEE FIG. 1B.) REPEAT THE SAME PROCEDURE WITH 2ND CROSS BEAM INTO SLOTS IN RACK END. (SEE FIG. 1) BE SURE CROSS BEAMS HAVE THE SAME WEIGHT CARRYING CAPACITY AND ARE INSTALLED AT THE SAME HEIGHT IN BOTH UPRIGHTS.

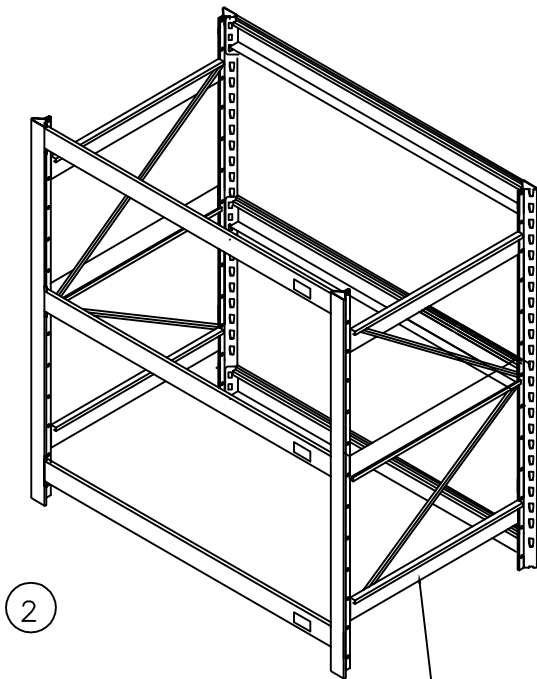

2

EACH RACK END SHOULD BE INSTALLED WITH DIAGONAL BRACING RUNNING IN THE OPPOSITE DIRECTION FROM THAT WHICH WAS PREVIOUSLY INSTALLED

# CAUTION!

ALL RACKS MUST HAVE A PAIR OF BEAMS AT FLOOR LEVEL. THE TIP OF THESE BEAMS MUST NOT EXCEED 6" ABOVE THE FLOOR TO ASSURE A SAFE AND STABLE UNIT.

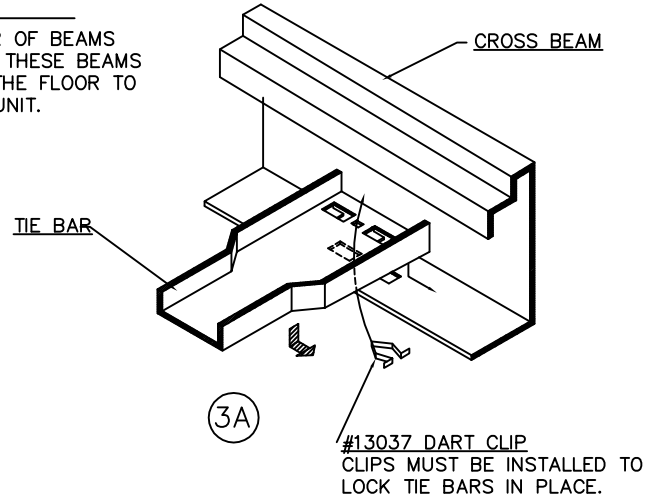
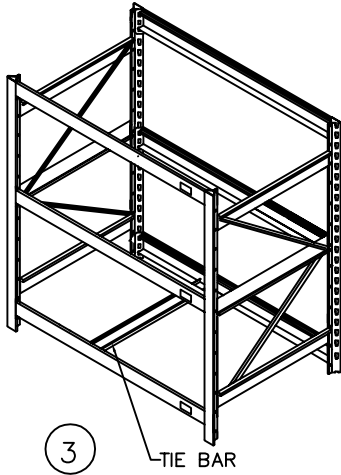

NOTE - TIE BARS MUST BE INSTALLED FOR MAXIMUM UNIT STRENGTH. ONE TIE BARS PER LEVEL FOR FOUR AND FIVE FOOT WIDTH. TWO TIE BARS PER LEVEL FOR SIX AND EIGHT FOOT WIDTH.

## "V" GRIP RACK ASSEMBLY INSTRUCTIONS

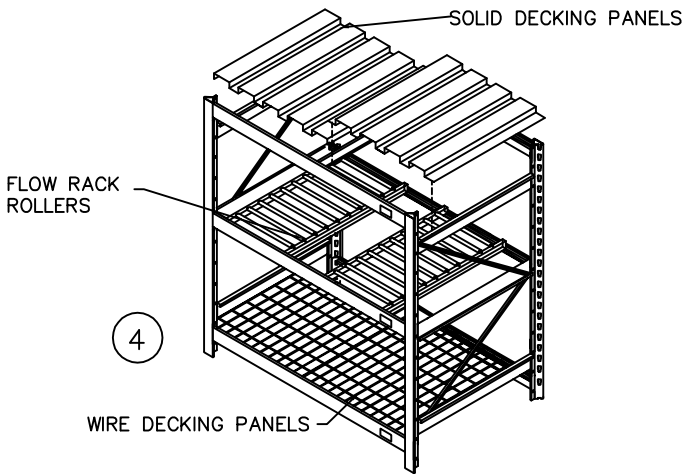

STEP 3. STAND ANOTHER RACK END VERTICALLY BUT WITH THE DIAGONAL BRACING RUNNING IN THE OPPOSITE DIRECTION FROM THE FIRST RACK END. INSERT HOOKS ON THE OPPOSITE ENDS OF THE TWO PARTIALLY ASSEMBLED CROSS BEAMS INTO CORRESPONDING SLOTS IN THE 2ND RACK END.

STEP 4. INSTALL REMAINING CROSS BEAMS INTO RACK BY HOOKING BOTH ENDS OF EACH CROSS BEAM INTO UPRIGHT SLOTS OF BOTH RACK ENDS. BE SURE EACH BEAM IS PARALLEL WITH THE FLOOR AND EACH PAIR OF BEAMS IS LOCATED AT THE SAME HEIGHT ON THE RACK ENDS.

STEP 5. INSTALL TIE BARS AS SHOWN IN FIGS. 3 & 3A. ASSEMBLE TIE BAR BY INSERTING HOOKS ON EACH END OF TIE BAR INTO SLOTS IN BOTTOM FLANGE OF BOTH CROSS BEAMS. (SEE FIG 3A.)

NOTE - ALL 6' AND 8' WIDE UNITS MUST HAVE 2 TIE BARS INSTALLED FOR EACH PAIR OF CROSS BEAMS.

DECKING - STEEL DECKING PANELS ARE OPTIONAL EQUIPMENT. IF REQUIRED, INSTALL AS SHOWN IN FIG. 4. NOTE - DECKING PANELS MAY BE PLACED IN RACK WITH SMALLER RIBS FACING EITHER UP OR DOWN. IMPORTANT - RIBS IN DECKING PANELS MUST SPAN FROM ONE CROSS BEAM TO ANOTHER WHICH IS FROM FRONT TO REAR IN THE RACK. ROLLERS FOR THE FLOW RACK UNITS SHOULD BE POSITIONED SO FRONT EDGE IS LOWER THAN THE BACK. FRONT SHOULD REST ON THE BOTTOM OF THE BEAM STEP. BACK SHOULD REST ON TOP OF BEAM.

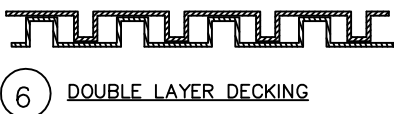
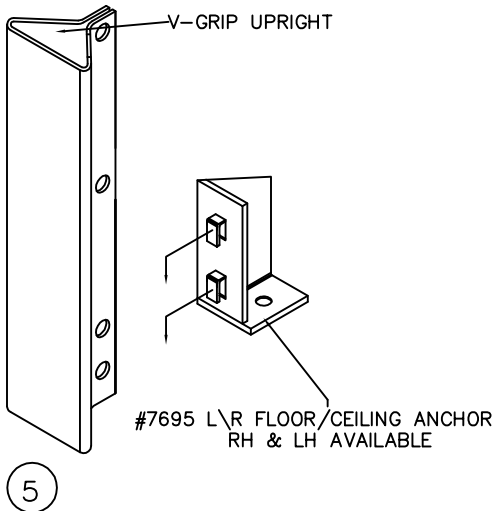

6. ADDITIONAL DECKING STRENGTH - WHENEVER ADDITIONAL STRENGTH IS DESIRED, PLACE A 2ND LAYER OF DECKING PANELS ON TOP OF ORIGINAL LAYER OF PANELS AS SHOWN IN FIG. 6.

# V GRIP RACK PARTS LIST

## RACK ENDS

	DEPTH				
	2'	3'	4'	15"	30"
5'	9301	9302	9303	9304	9305
6'	9306	9307	9308	9309	9310
7'	9311	9312	9313	9314	9315
8'	9316	9317	9318	9319	9320
10'	9326	9327	9328	9329	9330
15'	9342	9343	9344	9345	9346

## BEAMS

	LIGHT	MEDIUM	HEAVY
4'	9434	9444	9454
5'	9435	9445	9455
6'	9436	9446	9456
8'		9448	9458

## TIE BARS

2'	3'	4'	15"	30"
6522	6523	6524	6521	6525

## DECKING

PART #	WIDTH	DEPTH
16002	24"	24"
16003	24"	36"
16004	24"	48"
16022	30"	24"
16023	30"	36"
16024	30"	48"
16018	24"	15"
16019	24"	30"
16020	30"	15"
16021	30"	30"

## WIRE DECKING

PART #	WIDTH	DEPTH
6088	24"	24"
6089	24"	36"
6090	24"	48"
6138	30"	24"
6139	30"	36"
6140	30"	48"