

51140ASY

THIS DRAWING IS THE PROPERTY OF

EQUIPTO

Toll-Free: 800-323-0801

Toll-Free Fax: 888-859-2121

www.equipto.com

#295 WORKBENCH

ASSEMBLY INSTRUCTIONS

ASSEMBLY PROCEDURE:

1. INSTALLATION OF DOORS AS SHOWN IN STEP 1.
2. ASSEMBLE BACK PANEL TO THE BOTTOM SHELF AND ATTACH THEM TO THE DOOR FRAME.(STEP 2)
3. ATTACH PARTS FROM STEP 1 AND 2 TO THE R.H. AND L.H. BENCH END PANELS AS SHOWN IN STEP 3. TIGHTEN ALL FASTENERS SECURELY.
4. ASSEMBLE THE INTERMEDIATE SHELF AS SHOWN IN STEP 4. DO NOT TIGHTEN THE BOLTS UNTIL THE WORKBENCH IS COMPLETELY ASSEMBLED.
5. FASTEN STEEL BENCH TOP IN PLACE AS SHOWN IN STEP 5. TIGHTEN ALL FASTENERS SECURELY.

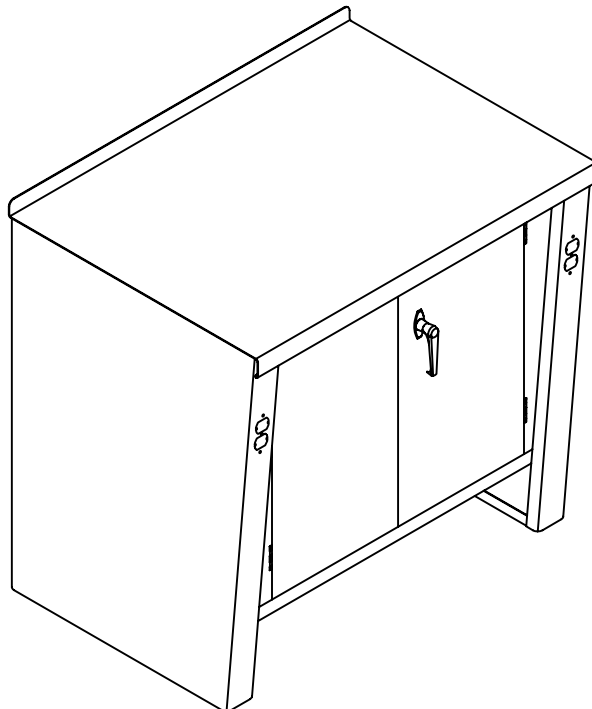

Step

2

BACK PANEL ASSEMBLY

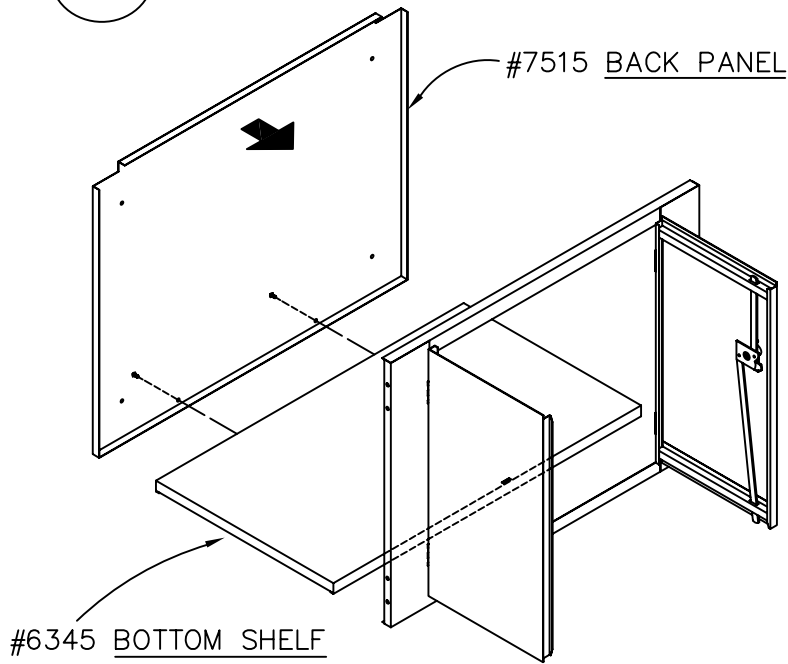

NOTE

PLACE REAR EDGE OF LOWER SHELF ON TOP OF FLANGE AT THE BOTTOM OF BACK PANEL AND BOLT THROUGH THE TWO HOLES. FRONT OF LOWER SHELF RESTS ON BOTTOM FLANGE OF DOOR FRAME. (NO BOLTS & NUTS NEEDED AT THIS POINT)

#13162 TRUSS HD MACH SCREW 1/4" X 1/2"
#13060 KEPS NUT 1/4" - 20

(2 PER BACK PANEL)

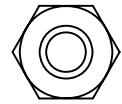
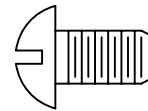

FULL SCALE

Step

3

END PANELS ASSEMBLY

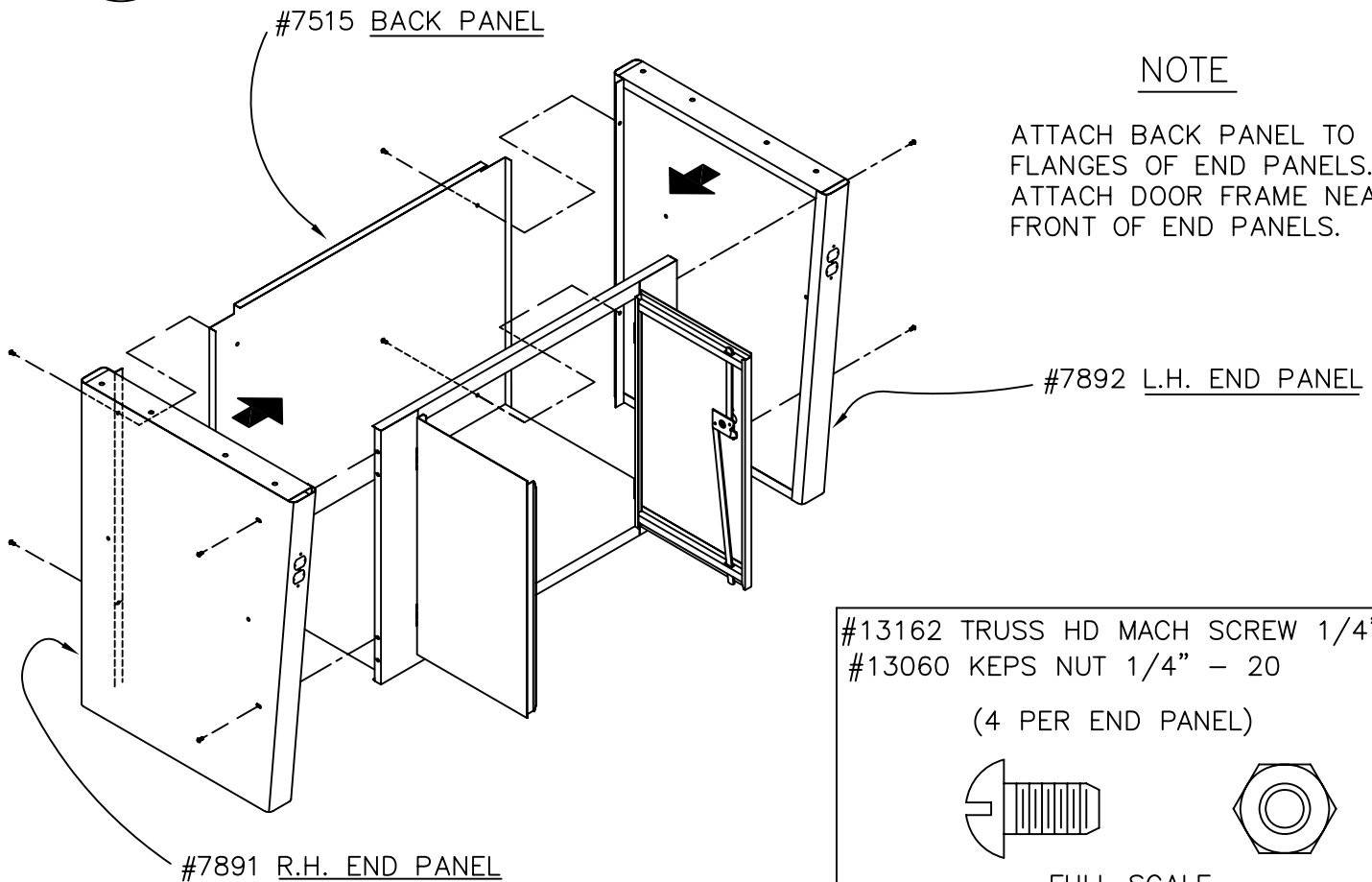

NOTE

ATTACH BACK PANEL TO REAR FLANGES OF END PANELS. ATTACH DOOR FRAME NEAR FRONT OF END PANELS.

#13162 TRUSS HD MACH SCREW 1/4" X 1/2"
#13060 KEPS NUT 1/4" - 20

(4 PER END PANEL)

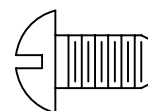

FULL SCALE

Step

1

INSTALLATION OF DOORS.

a. INSTALLATION OF DOOR HARDWARE

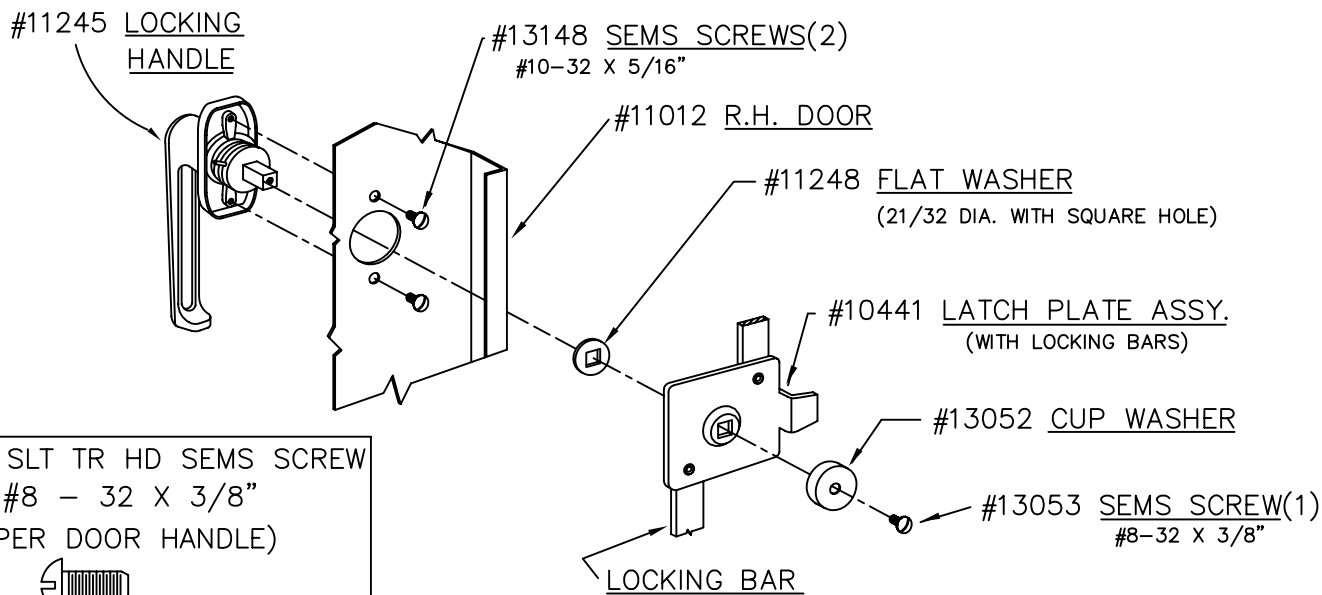

#13053 SLT TR HD SEMS SCREW
#8 - 32 X 3/8"
(1 PER DOOR HANDLE)



FULL SCALE

b. INSTALLATION OF DOORS

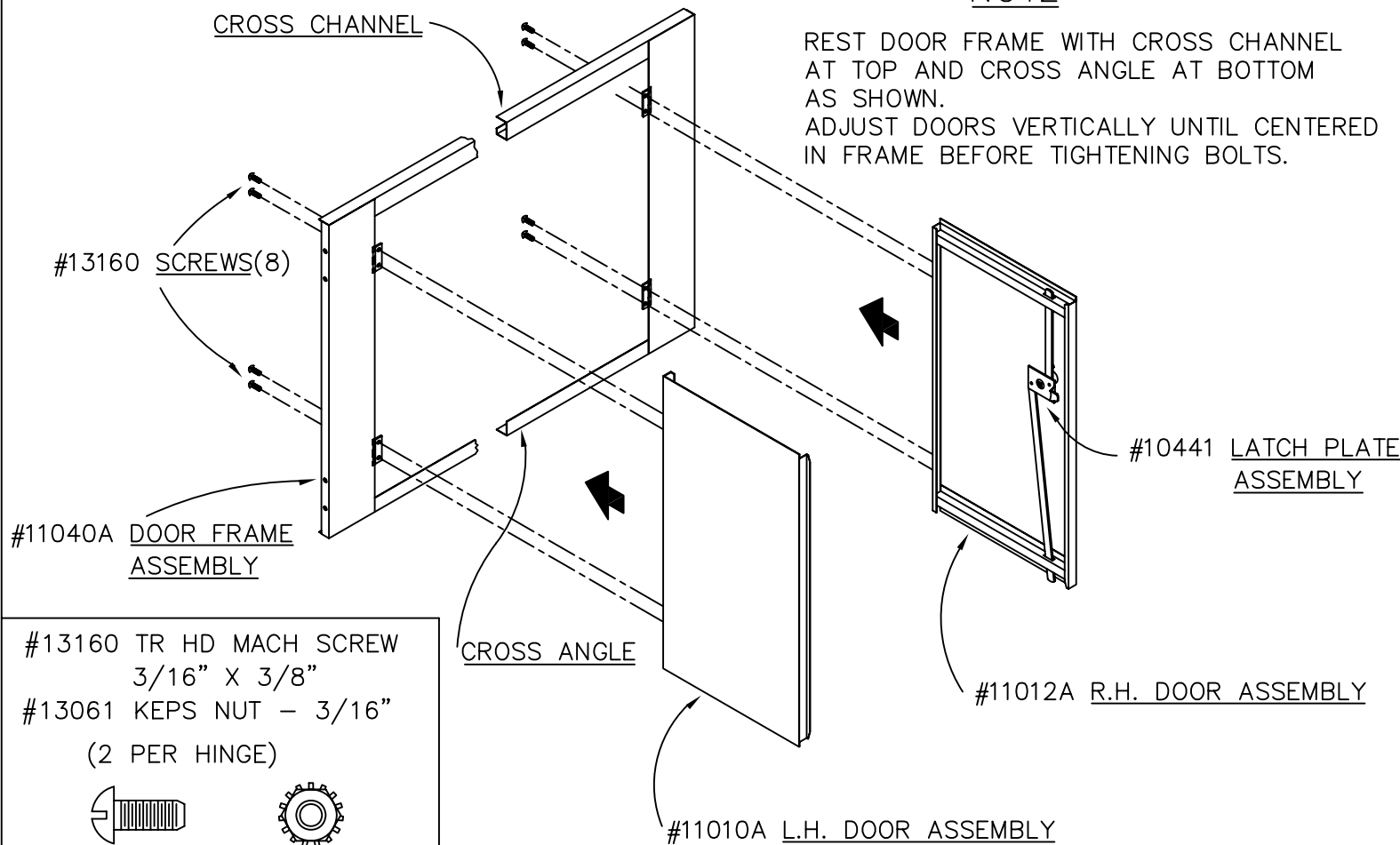

NOTE

REST DOOR FRAME WITH CROSS CHANNEL AT TOP AND CROSS ANGLE AT BOTTOM AS SHOWN.
ADJUST DOORS VERTICALLY UNTIL CENTERED IN FRAME BEFORE TIGHTENING BOLTS.

#13160 TR HD MACH SCREW
3/16" X 3/8"

#13061 KEPS NUT - 3/16"
(2 PER HINGE)



FULL SCALE

Step

4

INTERMEDIATE SHELF ASSEMBLY

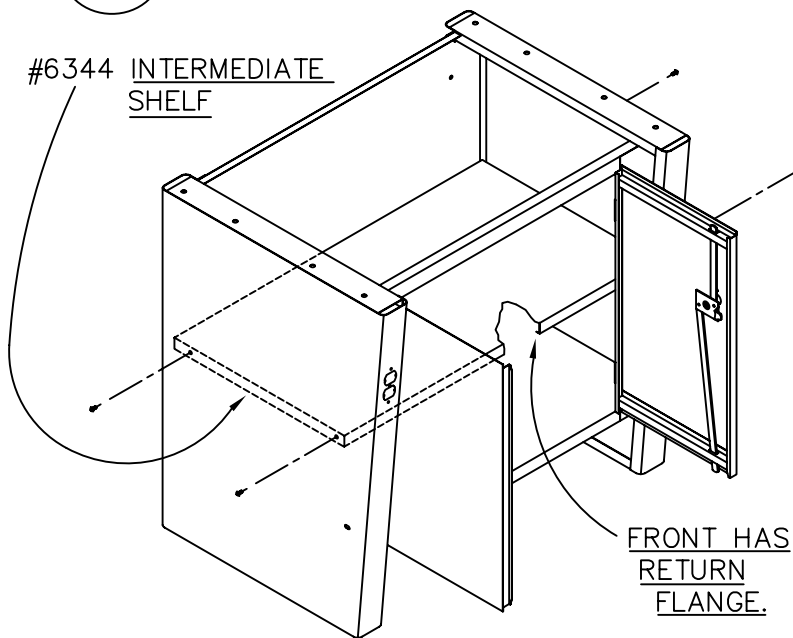

NOTE

INTERMEDIATE SHELF IS INSTALLED BY OPENING DOORS AND TILTING SHELF THROUGH DOOR FRAME.

#13162 TRUSS HD MACH SCREW 1/4" X 1/2"
#13060 KEPS NUT 1/4" - 20

(4 PER INTERMEDIATE SHELF)

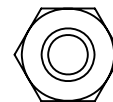
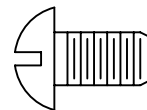

FULL SCALE

Step

5

STEEL TOP ASSEMBLY

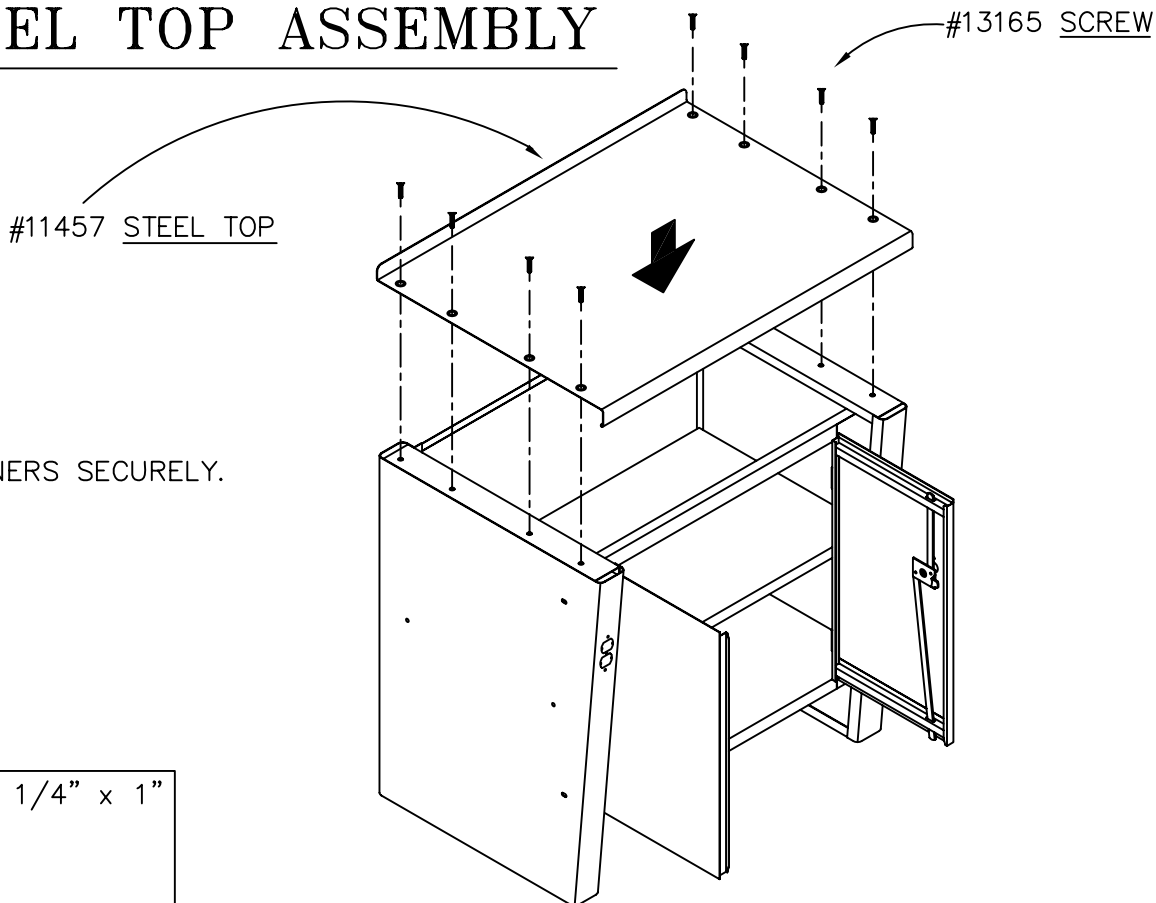

NOTE

TIGHTEN ALL FASTENERS SECURELY.

#13165 FLAT HEAD BOLT 1/4" x 1"

#13060 KEPS NUT 1/4"

(8 PER TOP)

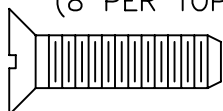

FULL SCALE

© 1991 BY EQUIPTO
REPRODUCTION STRICTLY FORBIDDEN