

51120ASY

---

# EQUIPTO

---

Closed Workbench with  
Back Panel Assembly  
Instructions

**READ INSTRUCTIONS BEFORE ASSEMBLING**

# CLOSED BACK BENCH ASSEMBLY INSTRUCTIONS

## A. #265,#270,#275 AND #280 SERIES

### B. ASSEMBLY PROCEDURE:

1. ASSEMBLE BACK PANEL AS SHOWN IN STEP 1. DO NOT TIGHTEN THE BOLTS UNTIL THE WORKBENCH IS COMPLETELY ASSEMBLED.
2. ASSEMBLE BOTTOM SHELF AS SHOWN IN STEP 2. DO NOT TIGHTEN THE BOLTS UNTIL THE WORKBENCH IS COMPLETELY ASSEMBLED.
3. ASSEMBLE THE SLIDING DOOR FRAME (IF DOOR IS FURNISHED) AS SHOWN IN STEP 3. TIGHTEN ALL FRAME FASTENERS SECURELY.
4. INSTALL THE SLIDING DOOR FRAME (IF DOOR IS FURNISHED) AS SHOWN IN STEP 4. DO NOT TIGHTEN THE BOLTS UNTIL THE WORKBENCH IS COMPLETELY ASSEMBLED.
5. ASSEMBLE THE INTERMEDIATE SHELF IN #265,#275 AND #280 SERIES AS SHOWN IN STEP 5. DO NOT TIGHTEN THE BOLTS UNTIL THE WORKBENCH IS COMPLETELY ASSEMBLED.
6. FASTEN STEEL BENCH TOP IN PLACE AS SHOWN IN STEP 6. TIGHTEN ALL FASTENERS SECURELY.
7. INSTALL FILLERS FOR 96" STEEL TOP AS SHOWN IN STEP 7.
8. WOOD TOP ADAPTER INSTALLATION AS SHOWN IN STEP 8.
9. ASSEMBLE WOOD TOP ON BENCH AS SHOWN IN STEP 9. TIGHTEN ALL FASTENERS SECURELY.
10. INSTALLATION OF DOORS (IF DOORS ARE FURNISHED) AS SHOWN IN STEP 10.
11. ADDITIONAL NOTES FOR INSTALLING HARDBOARD ON STEEL PLUGS AND DRAWER FOR #280 SERIES WORKBENCHES.

## C. LIST OF BENCH TOP MATERIALS AVAILABLE

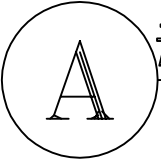

# #265, #270, #275 AND #280 SERIES

## #265 SERIES

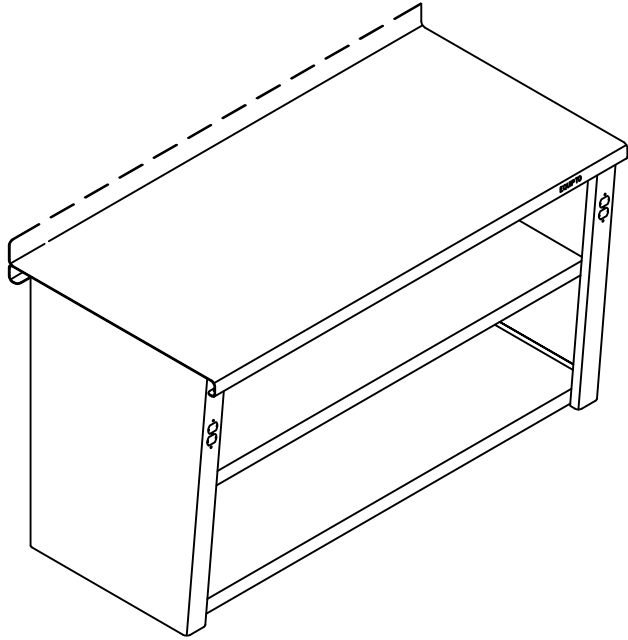

## #270 SERIES

(NO INTERMEDIATE SHELF)

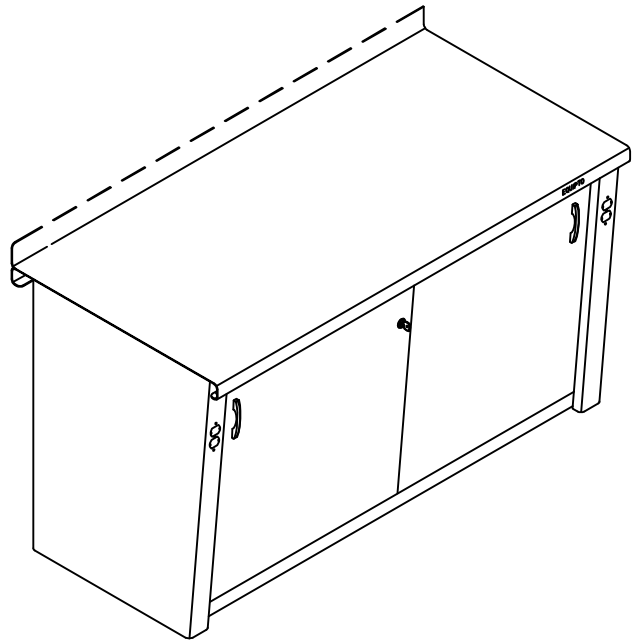

## #275 SERIES

(WITH INTERMEDIATE SHELF)

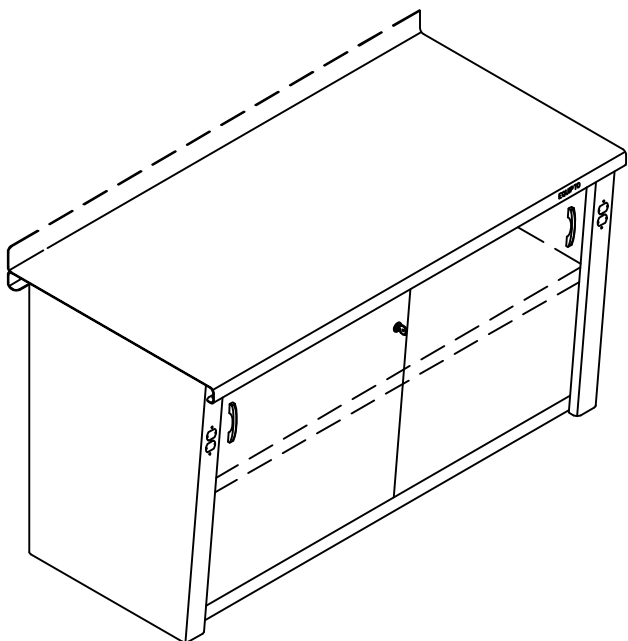

## #280 SERIES

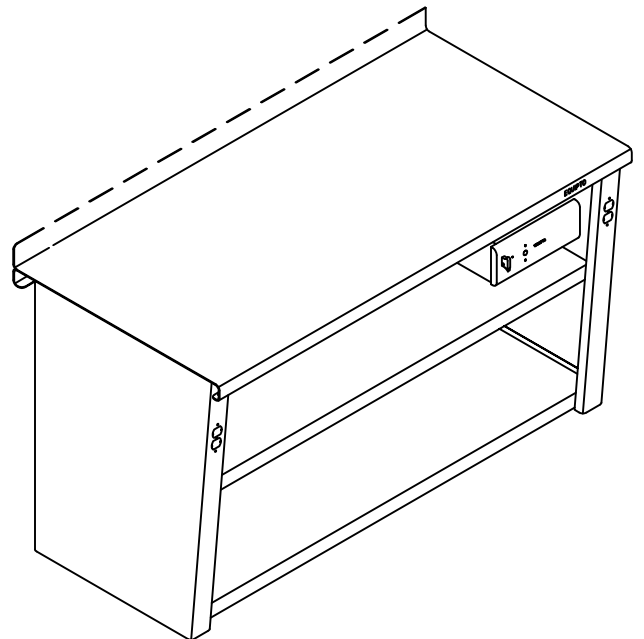

# B ASSEMBLY PROCEDURE

## Step

### 1

## BACK PANEL ASSEMBLY

### NOTE

INSTALL BOLTS AND NUTS AS SHOWN.  
DO NOT TIGHTEN THE BOLTS UNTIL THE  
WORKBENCH IS COMPLETELY ASSEMBLED.

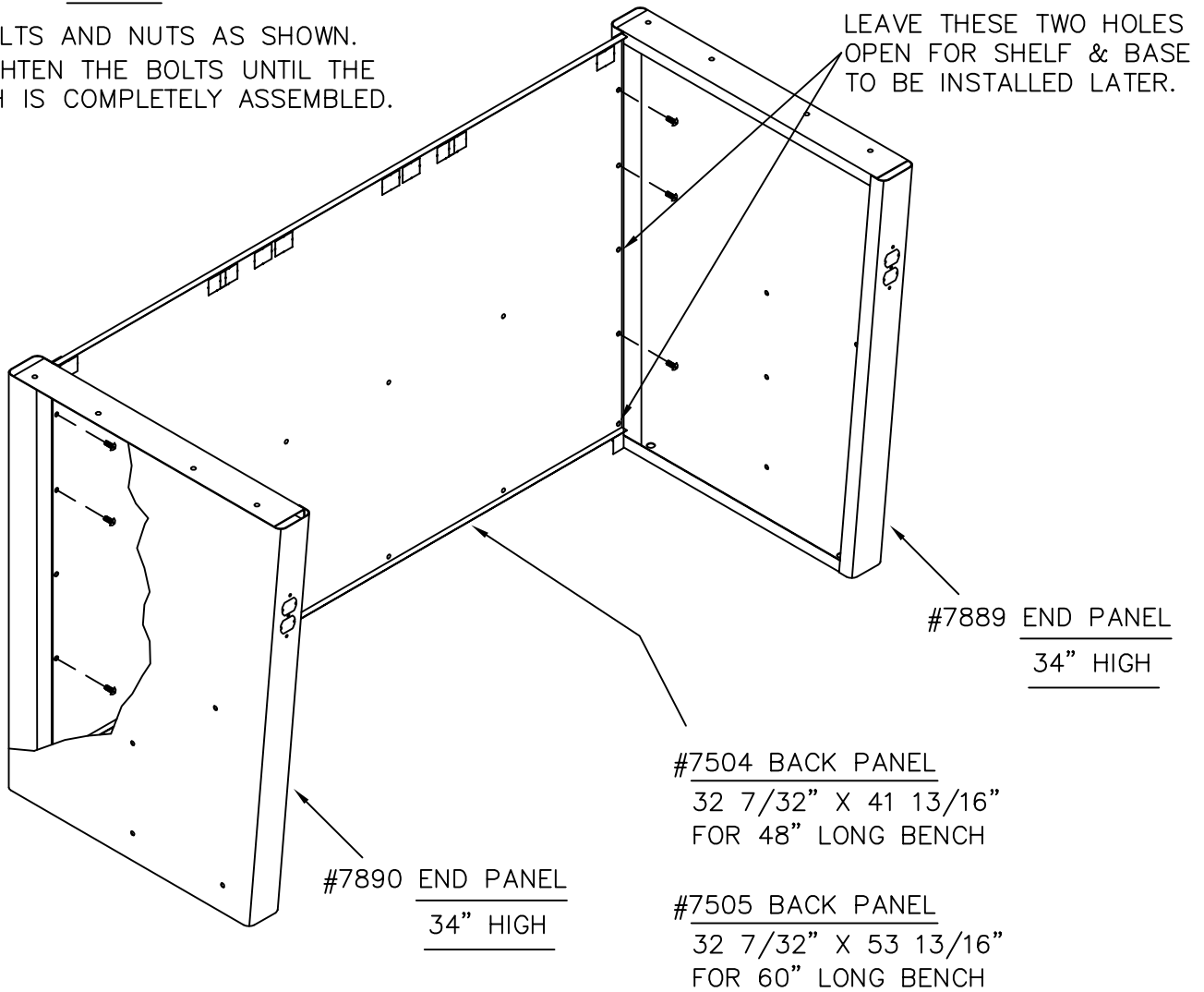

#13162 TRUSS HD MACH SCREW 1/4" X 1/2"  
#13060 KEPS NUT 1/4"

(6 PER BACK PANEL)

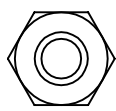
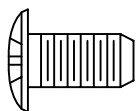

FULL SCALE

PATENT PENDING

# Step

## 2

## BOTTOM SHELF ASSEMBLY

### NOTE

INSTALL BOLTS AND NUTS AS SHOWN.  
DO NOT TIGHTEN THE BOLTS UNTIL THE  
WORKBENCH IS COMPLETELY ASSEMBLED.

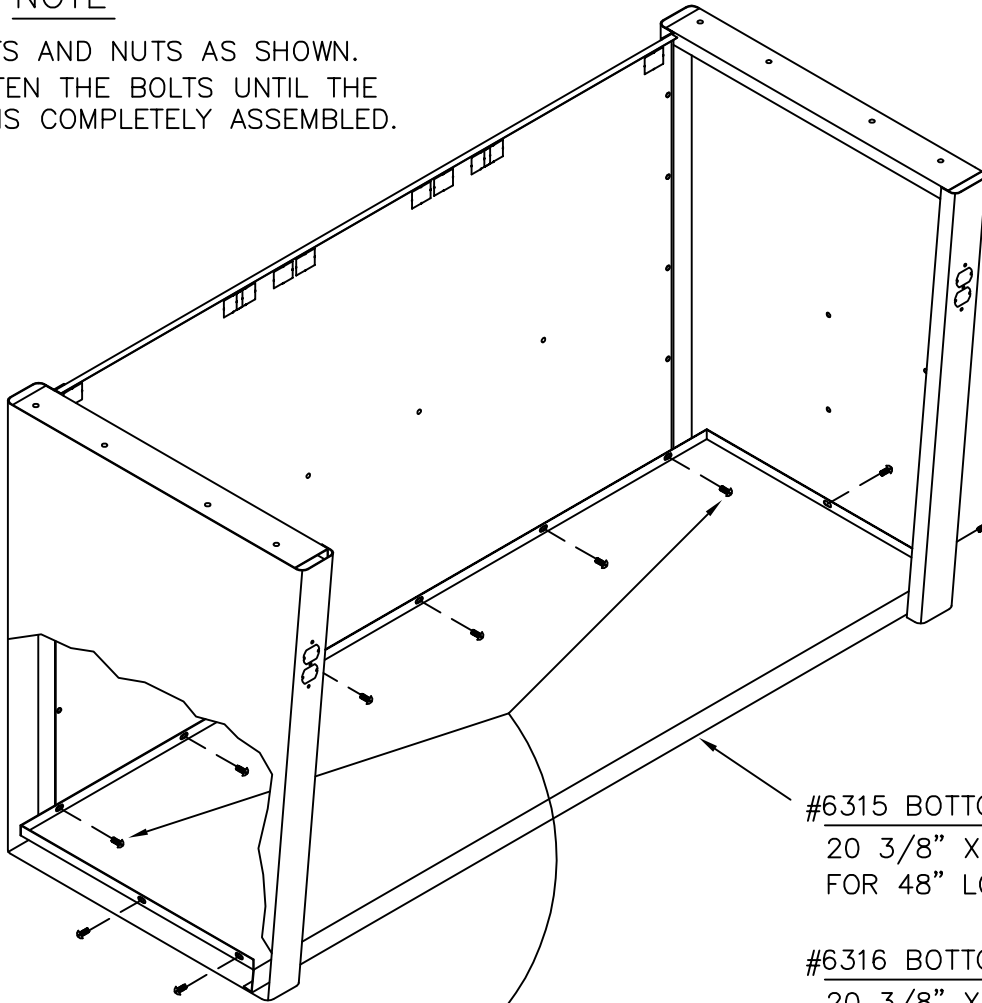

#6315 BOTTOM SHELF  
20 3/8" X 47 29/32"  
FOR 48" LONG BENCH

#6316 BOTTOM SHELF  
20 3/8" X 59 29/32"  
FOR 60" LONG BENCH

#6317 BOTTOM SHELF  
20 3/8" X 71 29/32"  
FOR 72" AND 96" LONG BENCH

### NOTE

COMMON SCREWS FOR BOTH BACK PANEL  
AND BOTTOM SHELF.(2)

#13162 TRUSS HD MACH SCREW 1/4" X 1/2"  
#13060 KEPS NUT 1/4"

(8 PER BOTTOM SHELF FOR 48" LONG BENCH)  
(10 PER BOTTOM SHELF FOR 60" LONG BENCH)  
(11 PER BOTTOM SHELF FOR 72" AND 90" LONG BENCH)

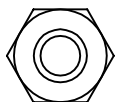
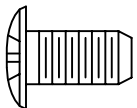

FULL SCALE

# Step

# 3

## SLIDING DOOR FRAME ASSEMBLY

### NOTE

ALL INDICATED FLANGES MUST FACE  
IN THE SAME DIRECTION.

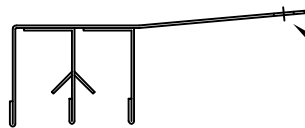

#12579 TOP TRACK ASS'Y  
FOR 48" LONG BENCH

#12577 TOP TRACK ASS'Y  
FOR 60" LONG BENCH

#12637 TOP TRACK ASS'Y  
FOR 72" AND 96" LONG BENCH

FLANGE FACE TO THE  
FRONT OF BENCH

FLANGE FACE TO THE  
FRONT OF BENCH

FLANGE FACE TO THE  
FRONT OF BENCH



#12616 END TRACK ASS'Y (2)  
FOR 48", 60", 72" AND  
96" LONG BENCH

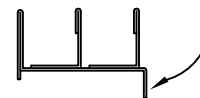

#12625 BOTTOM TRACK ASS'Y  
FOR 48" LONG BENCH

#12632 BOTTOM TRACK ASS'Y  
FOR 60" LONG BENCH

#12639 BOTTOM TRACK ASS'Y  
FOR 72" AND 96" LONG BENCH

#13162 TRUSS HD MACH SCREW 1/4" X 1/2"  
#13060 KEPS NUT 1/4"

(8 PER SLIDING DOOR FRAME)

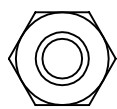
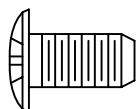

FULL SCALE

# Step

4

## SLIDING DOOR FRAME INSTALLATION

### NOTE

SHIFT THE DOOR FRAME UNTIL THE DOWN FLANGE OF THE BOTTOM TRACK IS HANGING OVER THE FRONT FLANGE OF THE BOTTOM SHELF. THE OUTSIDE FLANGES OF THE END TRACKS WILL FIT BEHIND THE FRONT FLANGES OF THE TWO END PANELS. SEE ILLUSTRATION.

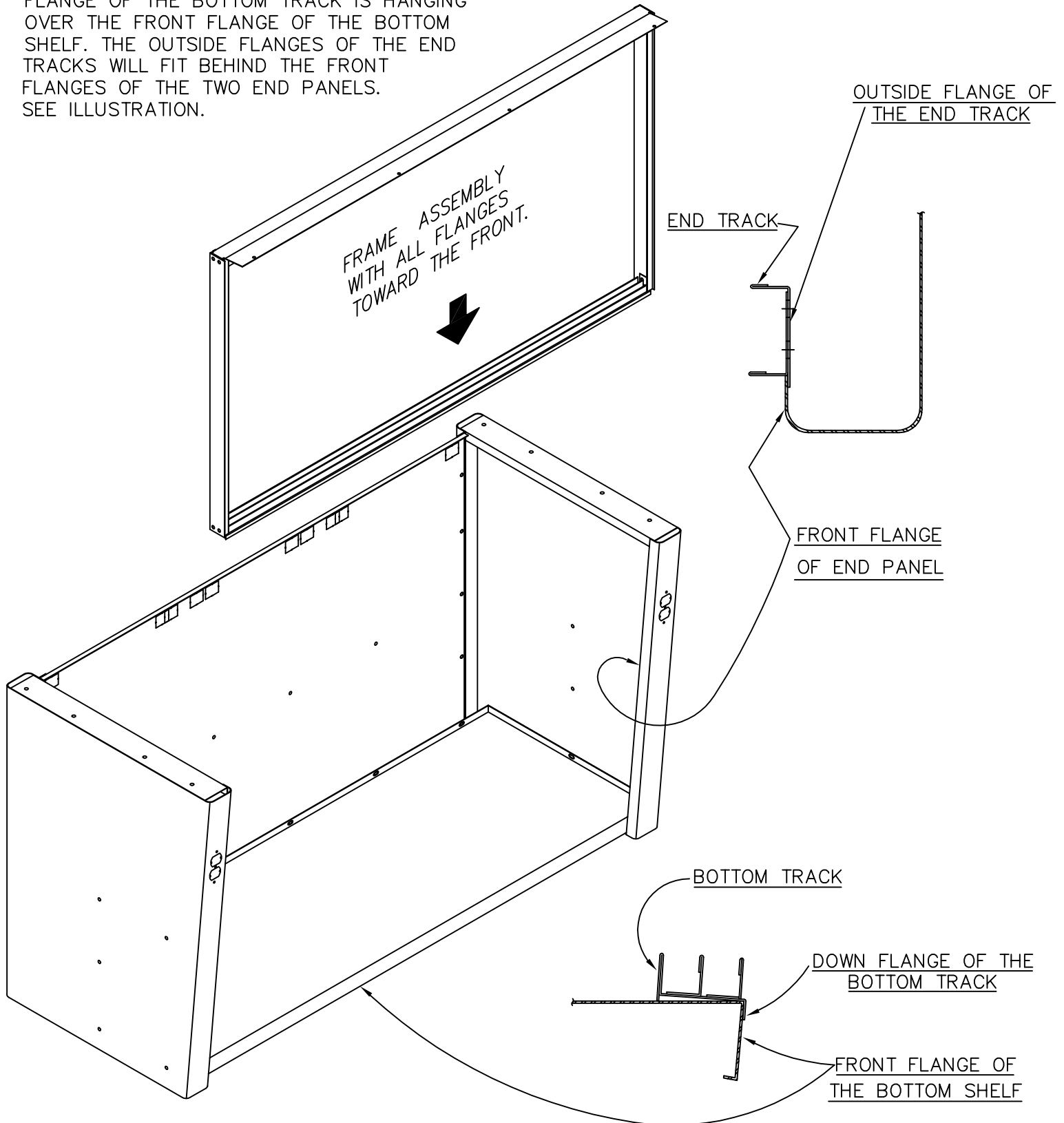

# Step

# 5

## INTERMEDIATE SHELF ASSEMBLY

### NOTE

INSTALL BOLTS AND NUTS AS SHOWN.  
DO NOT TIGHTEN THE BOLTS UNTIL THE  
WORKBENCH IS COMPLETELY ASSEMBLED.

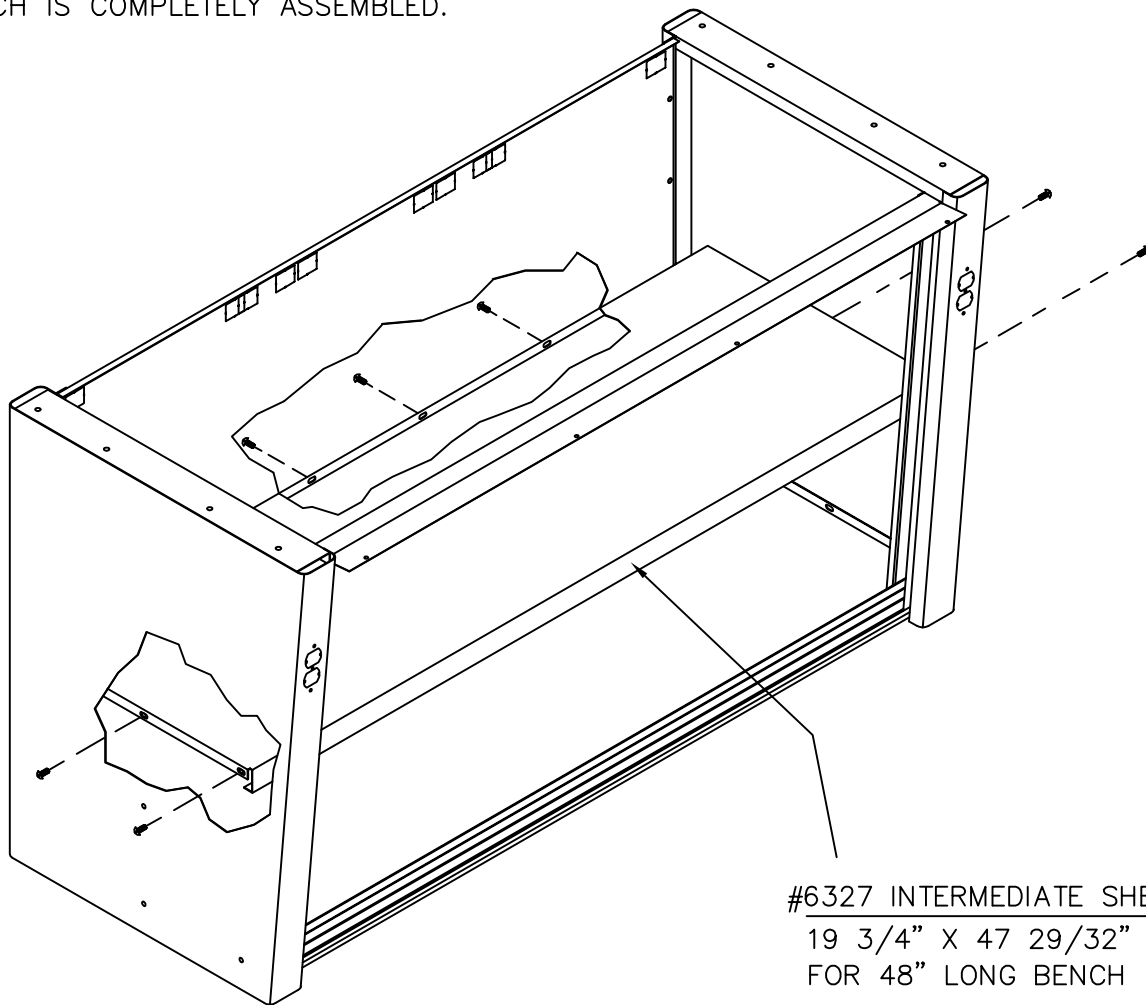

#6327 INTERMEDIATE SHELF  
19 3/4" X 47 29/32"  
FOR 48" LONG BENCH

#6328 INTERMEDIATE SHELF  
19 3/4" X 59 29/32"  
FOR 60" LONG BENCH

#6329 INTERMEDIATE SHELF  
19 3/4" X 71 29/32"  
FOR 72" AND 96" LONG BENCH

#13162 TRUSS HD MACH SCREW 1/4" X 1/2"

#13060 KEPS NUT 1/4"

(8 PER INTERMEDIATE SHELF FOR 48" LONG BENCH)  
(10 PER INTERMEDIATE SHELF FOR 60" LONG BENCH)  
(11 PER INTERMEDIATE SHELF FOR 72" AND 90" LONG BENCH)

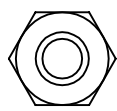
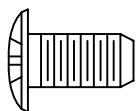

FULL SCALE



# Step

# 6

## STEEL TOP ASSEMBLY

### NOTE

OPTIONAL END RAILS AND AERIAL SHELF MUST BE ATTACHED TO THE TOP AT THIS POINT. IF YOU HAVE AN AERIAL SHELF SEE THOSE INSTALLATION INSTRUCTIONS.

END RAILS (16 GA.)		
LEFT HAND	SIZE	RIGHT HAND
#7417L	30" STEEL	#7417R

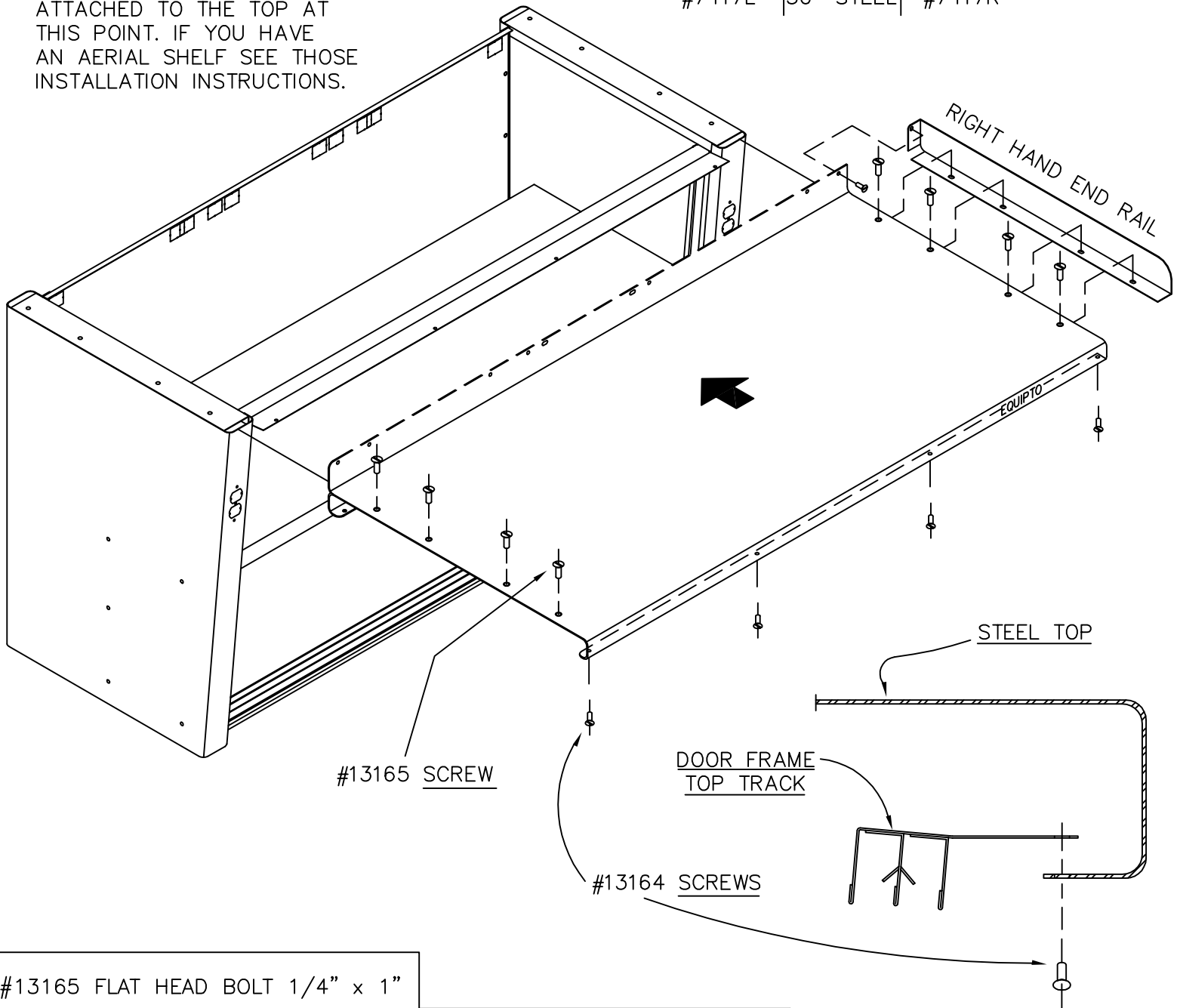

#13165 FLAT HEAD BOLT 1/4" x 1"  
#13060 KEPS NUT 1/4"

(8 PER TOP)

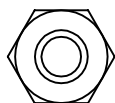

FULL SCALE

#13154 TRUSS HD MACH SCREW  
5/16" X 3/4"  
#13051 TWIN WHIZZ LOCKNUT  
5/16" - 18  
(1 PER END RAIL)

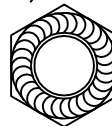

FULL SCALE

#13164 SLOTLESS TRUSS SCREW  
#10-24 X 3/8"  
#13061 TWIN WHIZZ LOCKNUT  
(4 PER TOP)

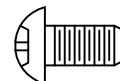

FULL SCALE

# Step

7

## FILLER INSTALLATION

### FOR 96" STEEL TOPS ONLY

FILLER (14 GA.)

FLANGE DOWN	SIZE	FLANGE UP
#7735	30"	#7737

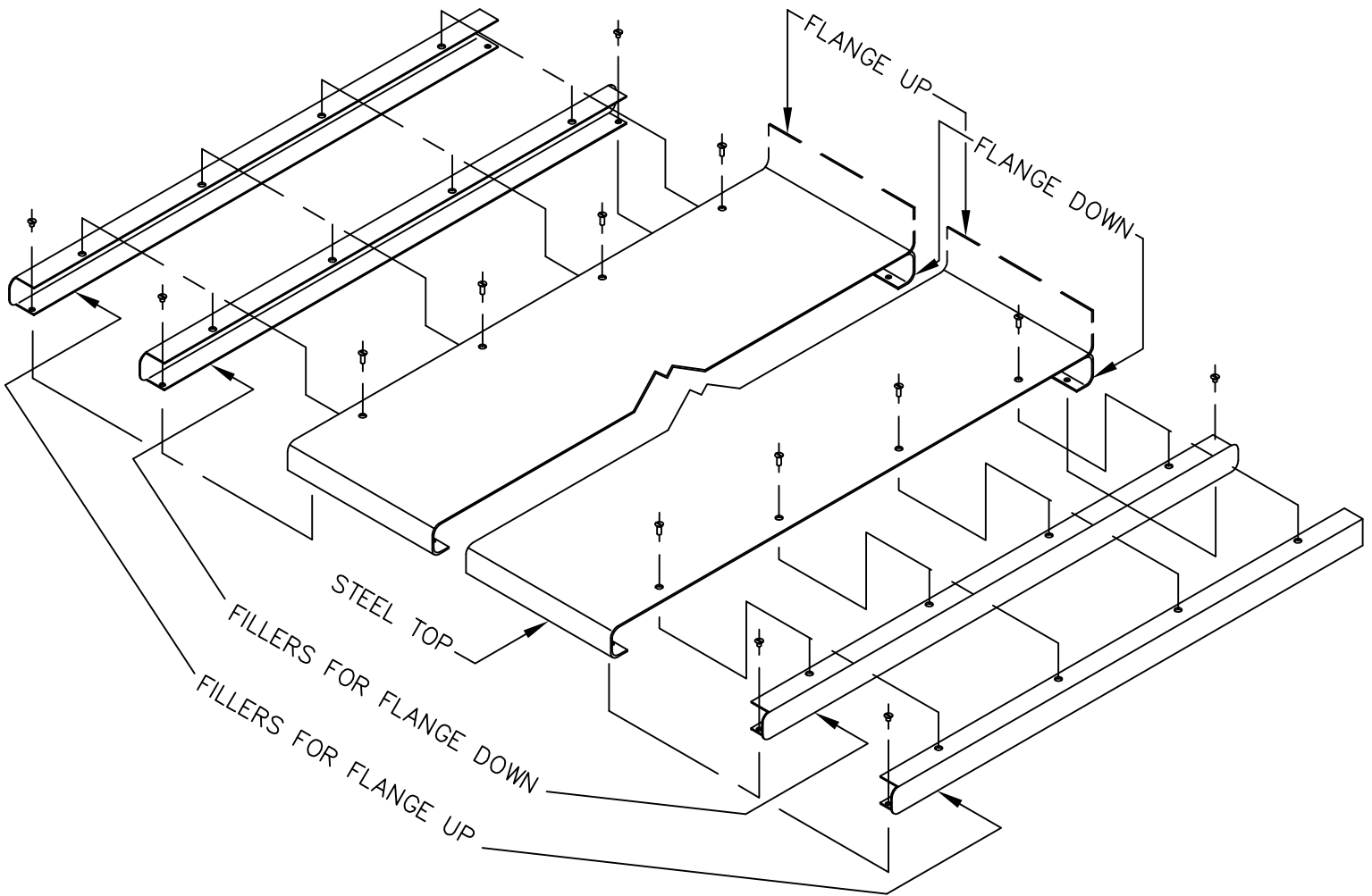

#13165 FLAT HEAD BOLT 1/4" x 1"  
#13060 KEPS NUT 1/4"

(8 PER TOP)

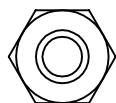

FULL SCALE

#13162 TRUSS HD MACH SCREW 1/4" x 1/2"  
#13060 KEPS NUT 1/4"

(2 PER FILLER FOR FLANGE DOWN)  
(1 PER FILLER FOR FLANGE UP)

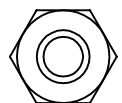
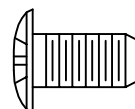

FULL SCALE

# Step

# 8

## WOOD TOP ADAPTER INSTALLATION

### a. INSTALLATION OF WOOD TOP ADAPTER.

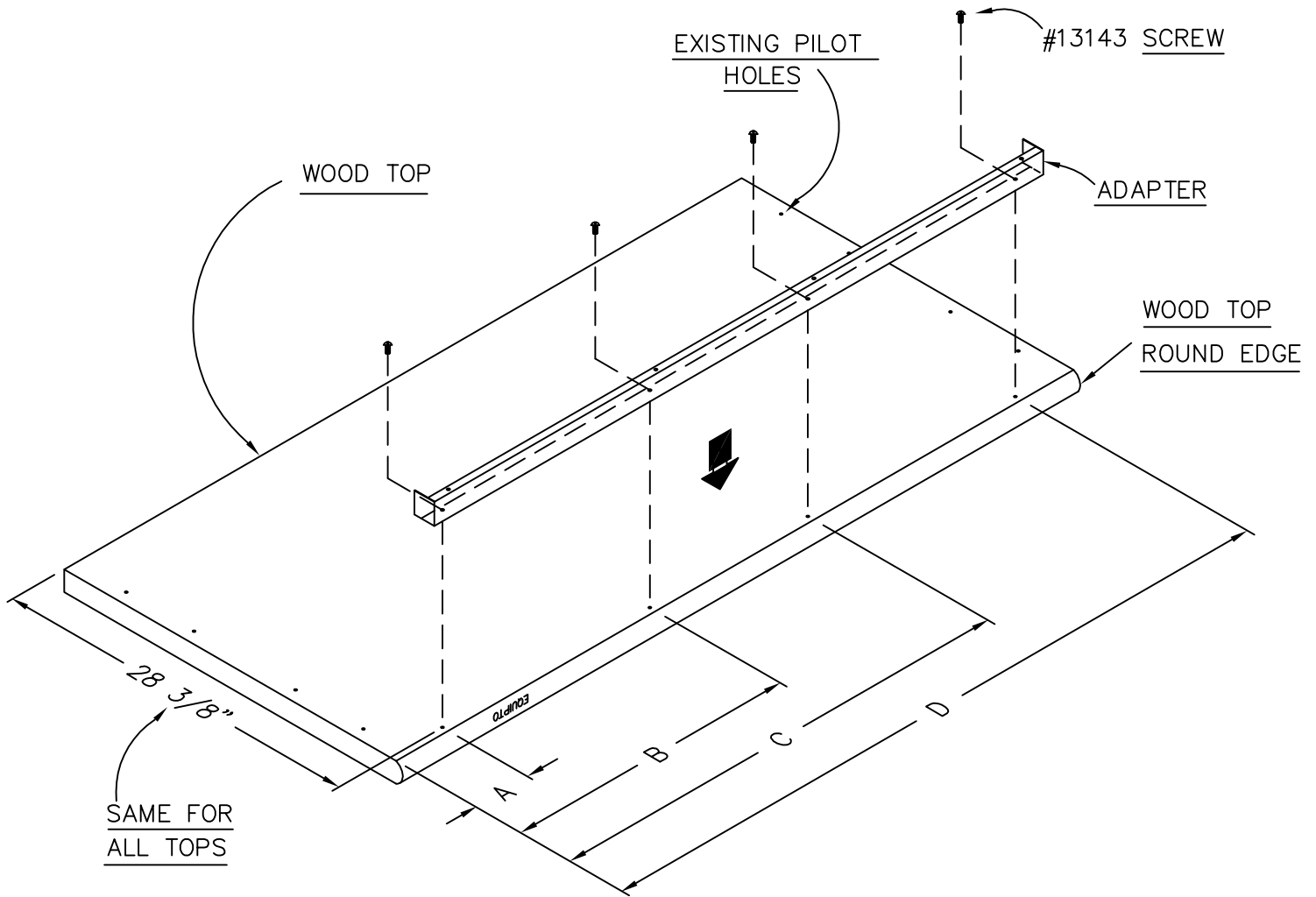

ADAPTER	#7714	#7715	#7716	#7716
TOP LENGTH	48"	60"	72"	96"
HOLE LOCATION	A	4 5/8"	4 5/8"	5 5/8"
	B	18 5/8"	23"	29"
	C	29 3/8"	37"	43"
	D	43 3/8"	55 3/8"	66 3/8"

#### NOTE

TURN THE WOOD TOP UPSIDE DOWN AND DRILL 1/8" DIA. X 5/8" DEEP PILOT HOLES AT THE LOCATIONS INDICATED.

#13143 SLT. PAN HD. SHT. MTL. SCREW  
#10-24 X 1/2"

(4 PER ADAPTER)



FULL SCALE

# Step

# 9

## WOOD TOP ASSEMBLY

### a. BACK AND END RAILS INSTALLATION

#### NOTE

OPTIONAL END AND BACK RAILS MUST BE ATTACHED AT THIS POINT.

#### NOTE

AFTER THE BACK RAIL IS IN POSITION AND FASTENED TO THE REAR FLANGES OF THE END RAILS, DRILL 3/16" DIA. X 1" DEEP PILOT HOLES IN THE REAR EDGE OF THE WOOD TOP.

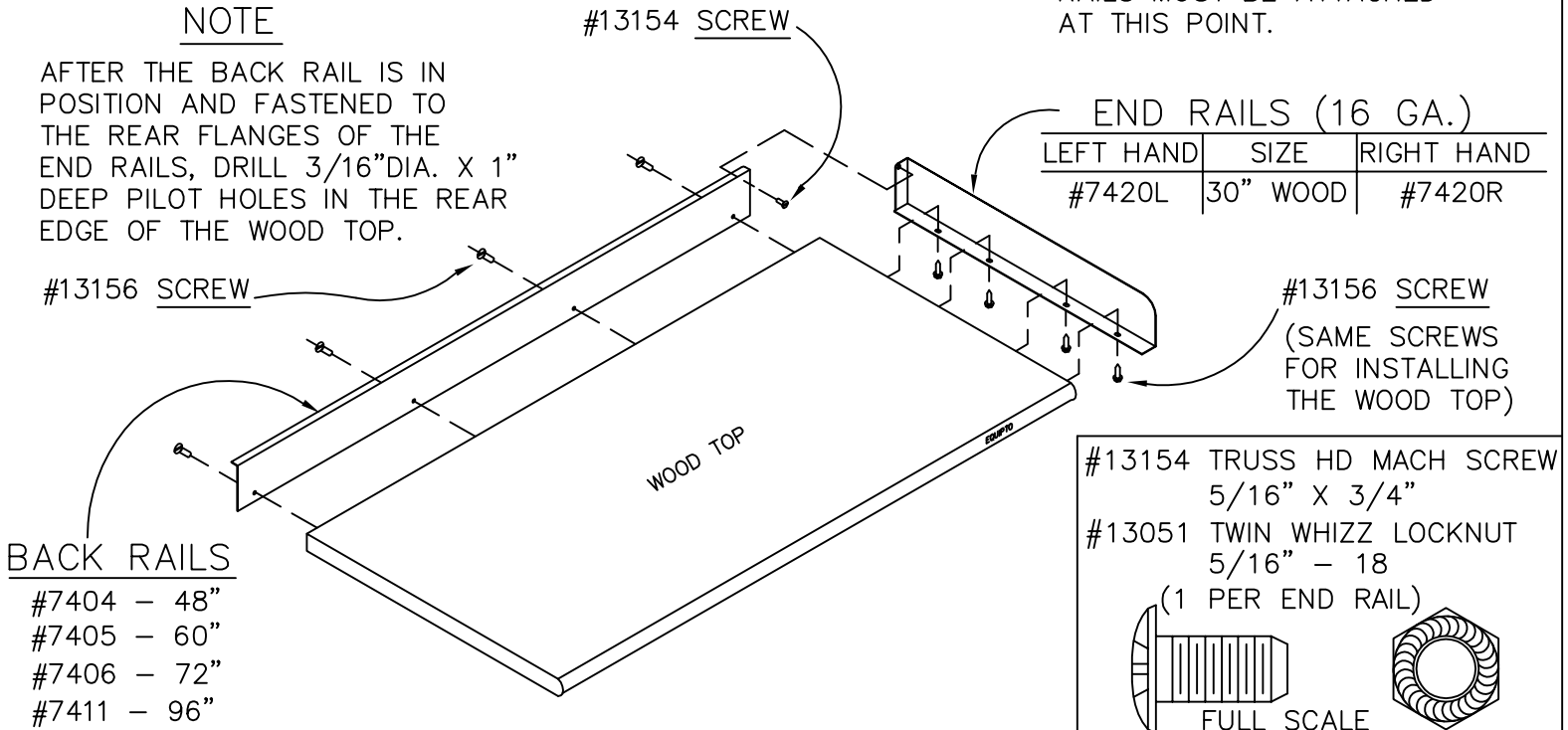

### b. INSTALLATION OF WOOD TOP.

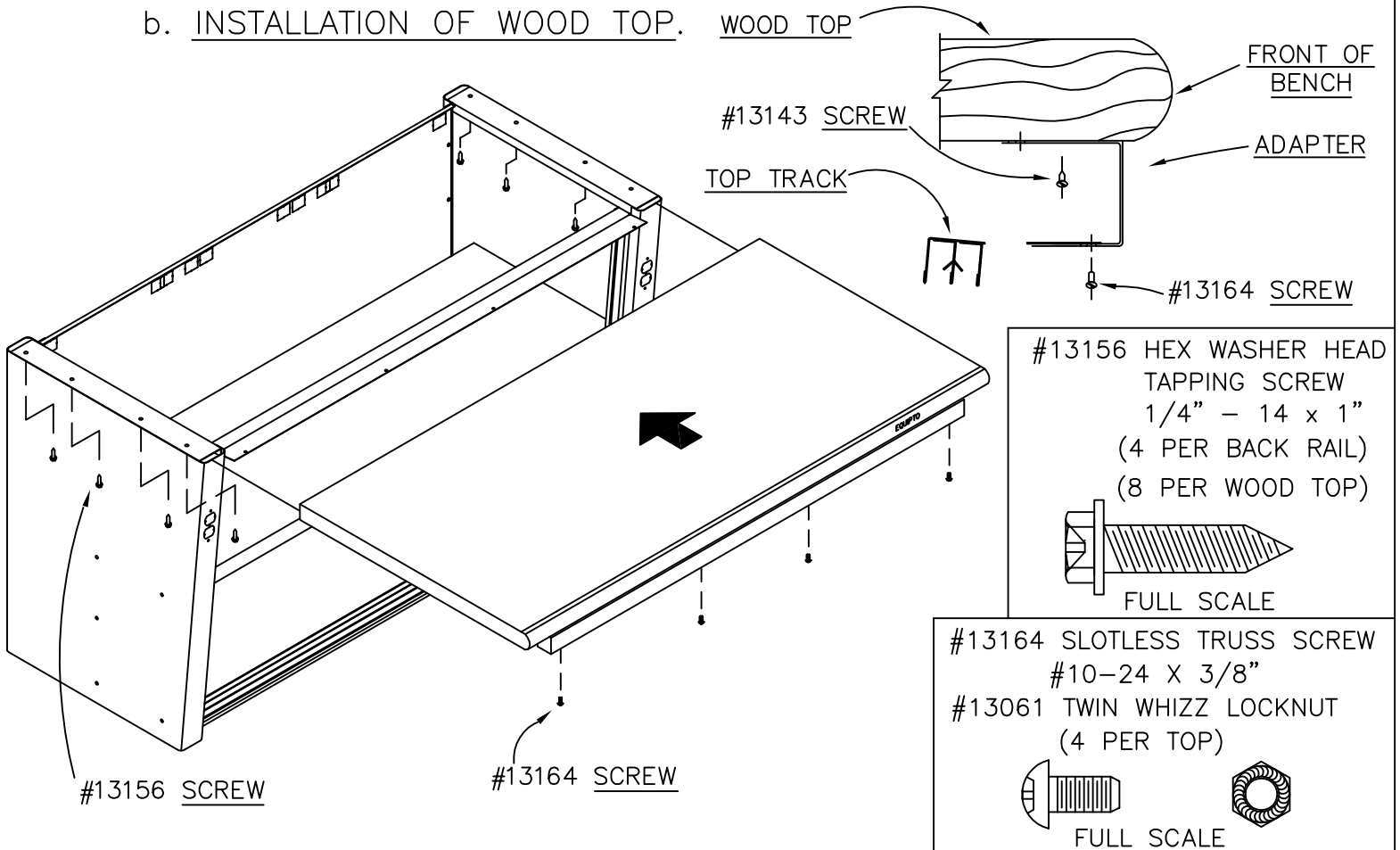

# Step

# 10

## SLIDING DOOR ASSEMBLY

### a. INSTALLATION OF DOOR HARDWARE

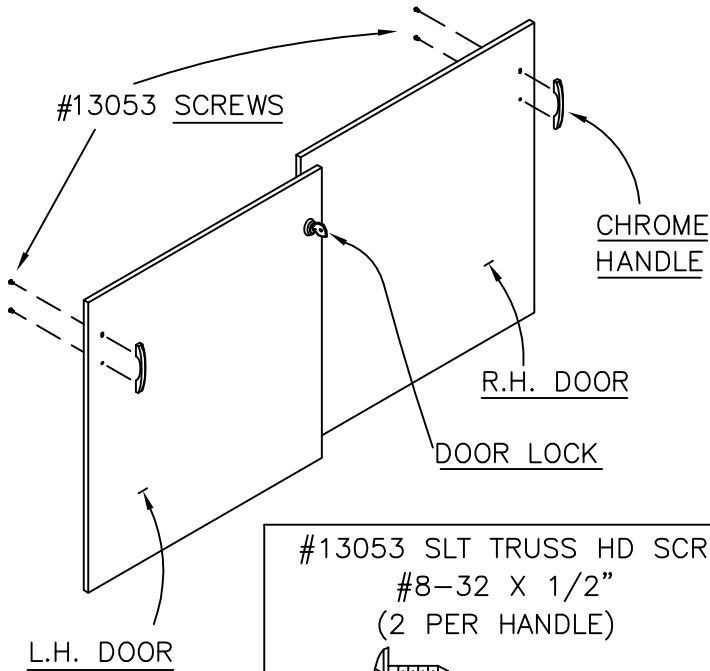

#13053 SLT TRUSS HD SCREW  
#8-32 X 1/2"  
(2 PER HANDLE)



FULL SCALE

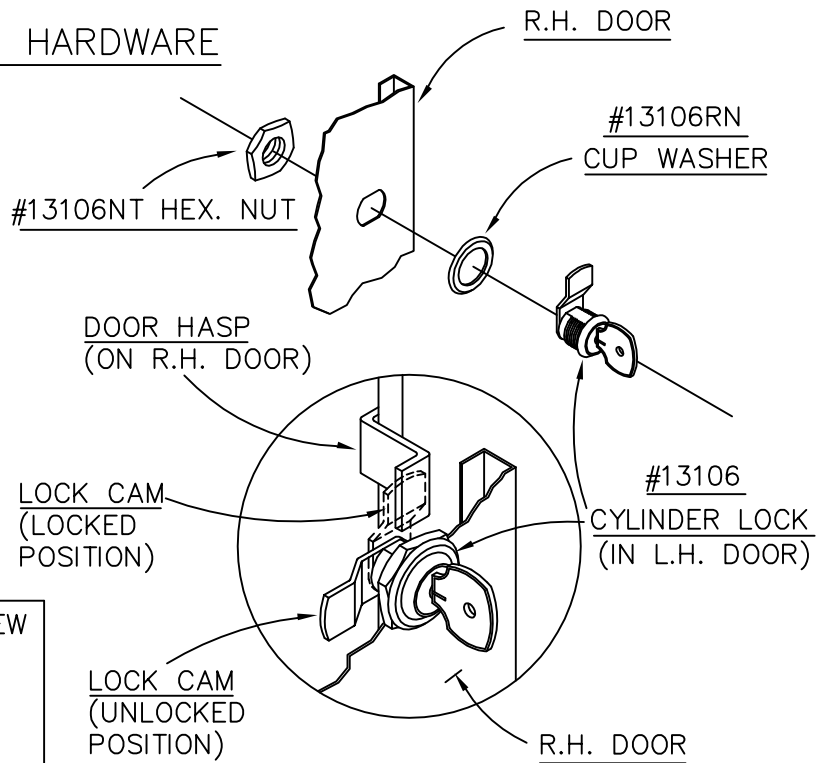

### b. INSTALLATION OF DOORS

#### NOTE

POSITION R.H. DOOR AT THE LEFT HAND OF FRAME AND INSERT IT AS SHOWN.

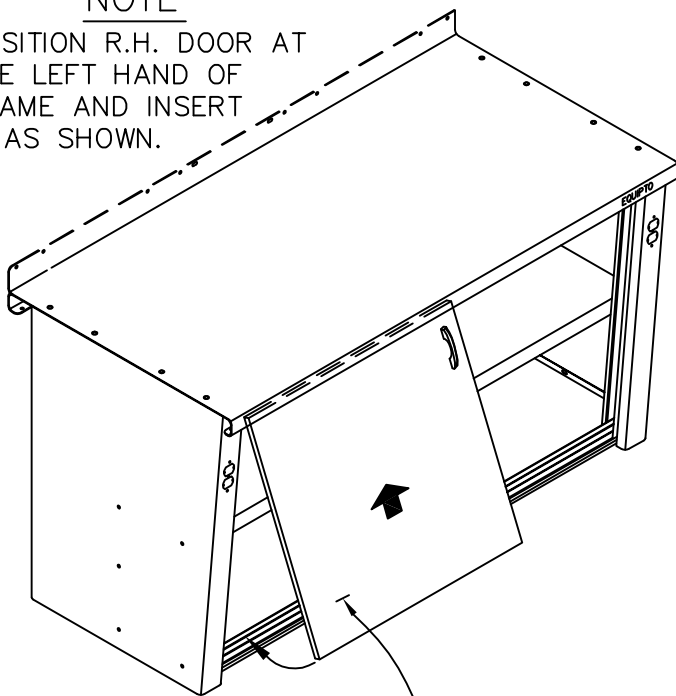

#### NOTE

POSITION L.H. DOOR AT R.H. END OF FRAME NEXT TO HANDLE OF R.H. DOOR AND INSERT IT AS SHOWN.

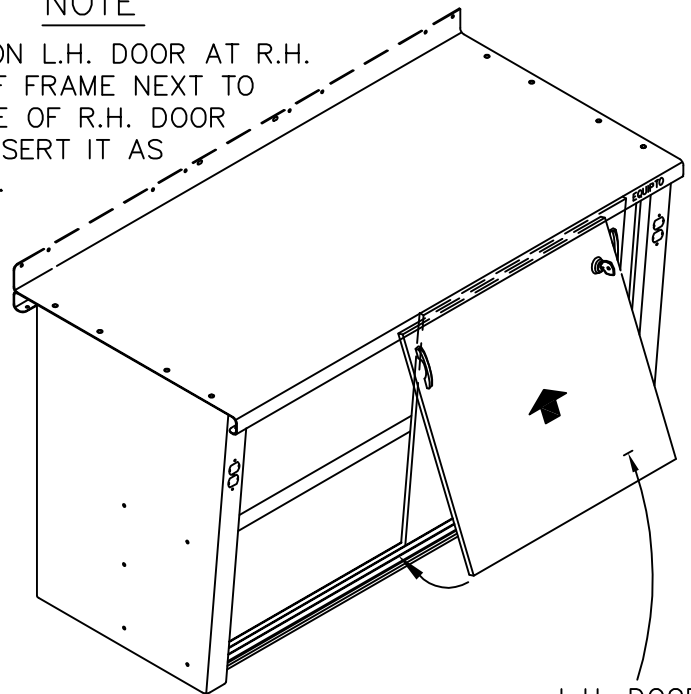

STEEL TOP

REAR HALF OF DOOR FRAME TOP TRACK

R.H. DOOR

SLIDING DOORS		
WIDTH	LEFT	RIGHT
48"	10990	10992
60"	10994	10996
72",96"	10998	11000

STEEL TOP

FRONT HALF OF DOOR FRAME TOP TRACK

L.H. DOOR

# 11 ADDITIONAL NOTES

a. FOR HARDBOARD ON STEEL, AFTER TOP IS ATTACHED INSERT PLUGS AS SHOWN.

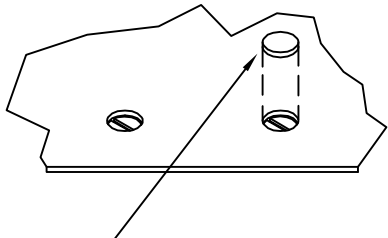

#10206-3/4" DIA. PLUG

b. WHEN BENCH DRAWER HAS TO BE INSTALLED (FOR #280 SERIES) REMOVE TWO KNOCKOUTS AT THE DESIRED LOCATION FOR THE DRAWER MOUNTING ANGLES.

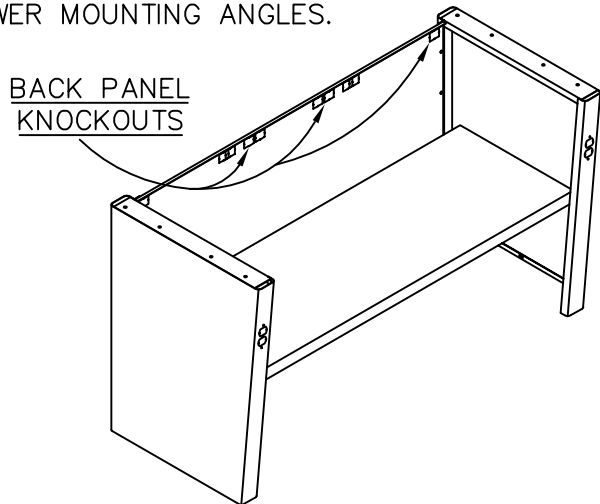

c. CLEANING INSTRUCTIONS— USE NON-ABRASIVE, NON-ACIDIC, NON-SOLVENT-BASED CLEANERS ONLY.

SEE ADDITIONAL ACCESSORY INSTRUCTIONS:

- #37ASY - WORKBENCH DRAWERS
- #75ASY - AERIAL SHELF & PICK RACK KITS
- #81ASY - PRODUCTION BOOSTER AERIAL SHELF

## C BENCH TOP MATERIALS AVAILABLE

### 1 MATERIALS FOR STEEL TOP

STEEL (12 GA.)			HARDBOARD ON STEEL (12 GA.)		
FLANGE DOWN	SIZE	FLANGE UP	FLANGE DOWN	SIZE	FLANGE UP
#11479D	30" x 48"	#11479	#441D4M	30" x 48"	#441U4M
#11480D	30" x 60"	#11480	#441D5M	30" x 60"	#441U5M
#11481D	30" x 72"	#11481	#441D6M	30" x 72"	#441U6M
#11482D	30" x 96"	#11482	#441D8M	30" x 96"	#441U8M

### 2 MATERIALS FOR WOOD TOP

#### BONDED WOOD 1-3/4" THICK

#### CONDUCTIVE 1-1/4" THICK

#12312	30" x 48"
#12305	30" x 60"
#12306	30" x 72"
#12380	30" x 96"

#12347	30" x 48"
#12348	30" x 60"
#12349	30" x 72"
#12378	30" x 96"

#### LAMINATED MAPLE 1-3/4" THICK

#12338	30" x 48"
#12339	30" x 60"
#12340	30" x 72"
#12376	30" x 96"

51120ASY