

127ASY

EQUIPTO

MODULAR CABINET
LEVELLER
Assembly Instructions

READ INSTRUCTIONS BEFORE ASSEMBLING

REV	ECH #	DESCRIPTION	DATE	ISSUED BY	CHK BY
A	-	Issued	07/14/08	PeS	JD

10065
CASTOR
CHANNEL

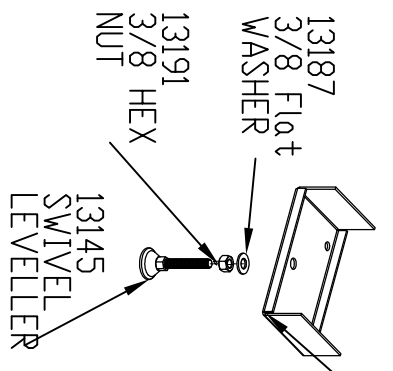

1) ATTACH 3/8 NUT TO LEVELLER FOOT. PLACE FLAT WASHER AND CASTOR CHANNEL ON TOP.

10064
NUT PLATE

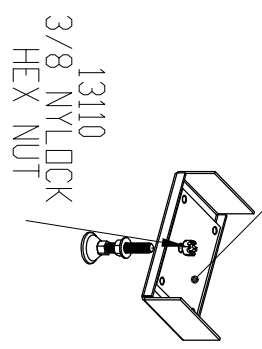

2) THREAD LEVELLER FOOT INTO NUT BLOCK. LEAVE ABOUT 1/4 IN. BETWEEN WASHER AND CASTOR CHANNEL. THREAD NYLLOCK NUT INTO END OF LEVELLER FOOT. LEAVE ABOUT 1-1/2 TO 2 THREADS SHOWING ON TOP.

3) INSERT BLOCK INTO LIFT CHANNEL OPENING WITH LEVELLER FOOT OUTWARD
NOTE: FLAT WASHER MUST BE TO THE UNDER-SIDE OF THE CHANNEL. (CABINET NOT SHOWN FOR CLARITY.)

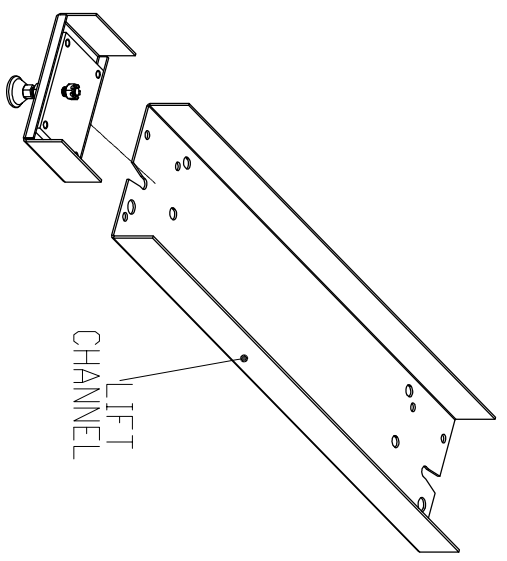

4) ALIGN HOLES. SECURE WITH (4) 5/16-18 BOLTS AND FLAT WASHERS

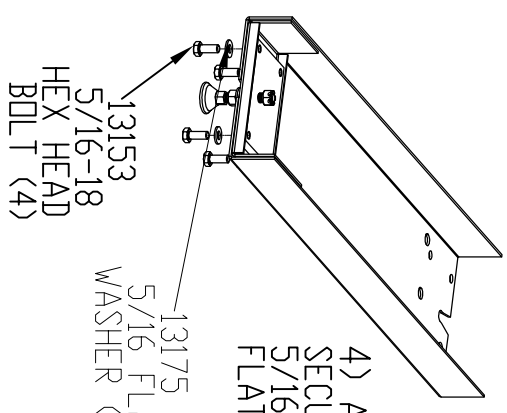

5) TIGHTEN 3/8 NUT FINGER TIGHT. REPEAT STEPT 1 - 4 FOR REMAINING LEVELLER UNIT. NOTE: AFTER CABINETS HAVE BEEN LEVELLED, POSITION MUST BE LOCKED BY TIGHTENING 3/8 NUT AGAINST CHANNEL.

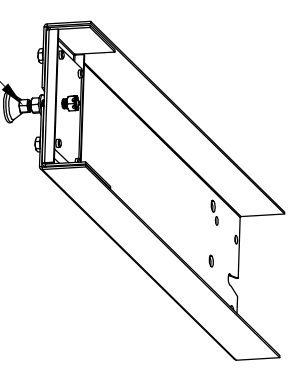

ADJUSTMENTS MADE BY TURNING HEX ON SWIVEL. COUNTER-CLOCKWISE TO RAISE AND CLOCKWISE TO LOWER.

		CONFIDENTIAL: This document and all information contained herein is the property of Consolidated Storage Companies, Inc. and is not to be disclosed to unauthorized persons or reproduced by any means, or used for any means, or used for any purpose other than that submitted without express written permission from Consolidated Storage Companies, Inc.	
TITLE: MODULAR CABINET LEVELLER INSTALLATION INSTRUCTIONS		SCALE: 1:1	SHEET: 1 of 1
DRAWING NUMBER: 127ASY	REVISION: A	DATE: 07/14/08	BY: PeS